

BLADE

SERIES

Automotive Data Solutions Inc.

INSTALL GUIDE

GM2

BLADE-AL(DL)-GM2

AVAILABLE FOR: ADS-BLADE AL

Rev. Date: March 23, 2012

Doc. No.: ##8863##

20120321

VERSION FRANÇAISE DISPONIBLE EN LIGNE AU WWW.BLADEUPDATE.COM

PLEASE VISIT WWW.BLADEUPDATE.COM FOR COMPLETE PRODUCT DETAILS

The brand names and logos found in this guide are property of their respective owners. Automotive Data Solutions Inc. © 2012

PONTIAC.

CHEVROLET

 SATURN®

NOTICE: The manufacturer will accept no responsibility for any electrical damage resulting from improper installation of this product, be that either damage to the vehicle itself or to the installed device. This device must be installed by a certified technician. This guide has been written for properly trained technicians; a certain level of skill & knowledge is therefore assumed. Please review the Installation Guide carefully before beginning any work.

INSTALL TYPE SELECTION

MAKE	MODEL	YEAR	INSTALL TYPE	FEATURES														
				DATA IMMOBILIZER BYPASS	ARM OEM ALARM	DISARM OEM ALARM	DOOR LOCK ¹	DOOR UNLOCK ¹	PRIORITY UNLOCK ¹	TRUNK/HATCH RELEASE ¹	PUDDLE LIGHT CTRL ²	DOOR STAT OUTPUT	TRUNK STAT OUTPUT	TACHOMETER OUTPUT	BRAKE PEDAL STAT OUTPUT ³	E-BRAKE OUTPUT ³	RAP SHUTDOWN CTRL	
CHEVROLET	Cobalt	05-06	1	•	•	•	•	•	•	•	•	•	•	•	•	•	•	•
	Cobalt	07-10	2	•	•	•	•	•	•	•	•	•	•	•	•	•	•	•
	HHR	06	1	•	•	•	•	•	•	•	•	•	•	•	•	•	•	•
	HHR	07-11	2	•	•	•	•	•	•	•	•	•	•	•	•	•	•	•
	Malibu Classic	04-07	1	•	•	•	•	•	•	•	•	•	•	•	•	•	•	•
	Malibu	07-12	2	•	•	•	•	•	•	•	•	•	•	•	•	•	•	•
	Malibu Hybrid	08-12	2	•	•	•	•	•	•	•	•	•	•	•	•	•	•	•
	Malibu MAXX	04-06	1	•	•	•	•	•	•	•	•	•	•	•	•	•	•	•
	Malibu MAXX	07-09	2	•	•	•	•	•	•	•	•	•	•	•	•	•	•	•
PONTIAC	G6	05-06	1	•	•	•	•	•	•	•	•	•	•	•	•	•	•	•
	G6	07-09	2	•	•	•	•	•	•	•	•	•	•	•	•	•	•	•
	Pursuit / G5	05-06	1	•	•	•	•	•	•	•	•	•	•	•	•	•	•	•
	Pursuit / G5	07-10	2	•	•	•	•	•	•	•	•	•	•	•	•	•	•	•
	Solstice	06	1	•	•	•	•	•	•	•	•	•	•	•	•	•	•	•
	Solstice	07-09	2	•	•	•	•	•	•	•	•	•	•	•	•	•	•	•
SATURN	Aura / Hybrid	07-10	2	•	•	•	•	•	•	•	•	•	•	•	•	•	•	•
	Sky	07-09	2	•	•	•	•	•	•	•	•	•	•	•	•	•	•	•

NOTE

I The 10th character in the Vehicle Identification Number (VIN) indicates the manufacturing year: 1=2001; 2=2002; 3=2003...

¹ Doorlocks and trunk release features on the module will not operate on vehicles that are not equipped with OEM keyless entry.

² If puddle light function is active in vehicle settings.

³ Available on AL-CA modules in DATA and STANDARD mode.
Available on DL modules in DATA mode only.

COMPONENT LOCATOR

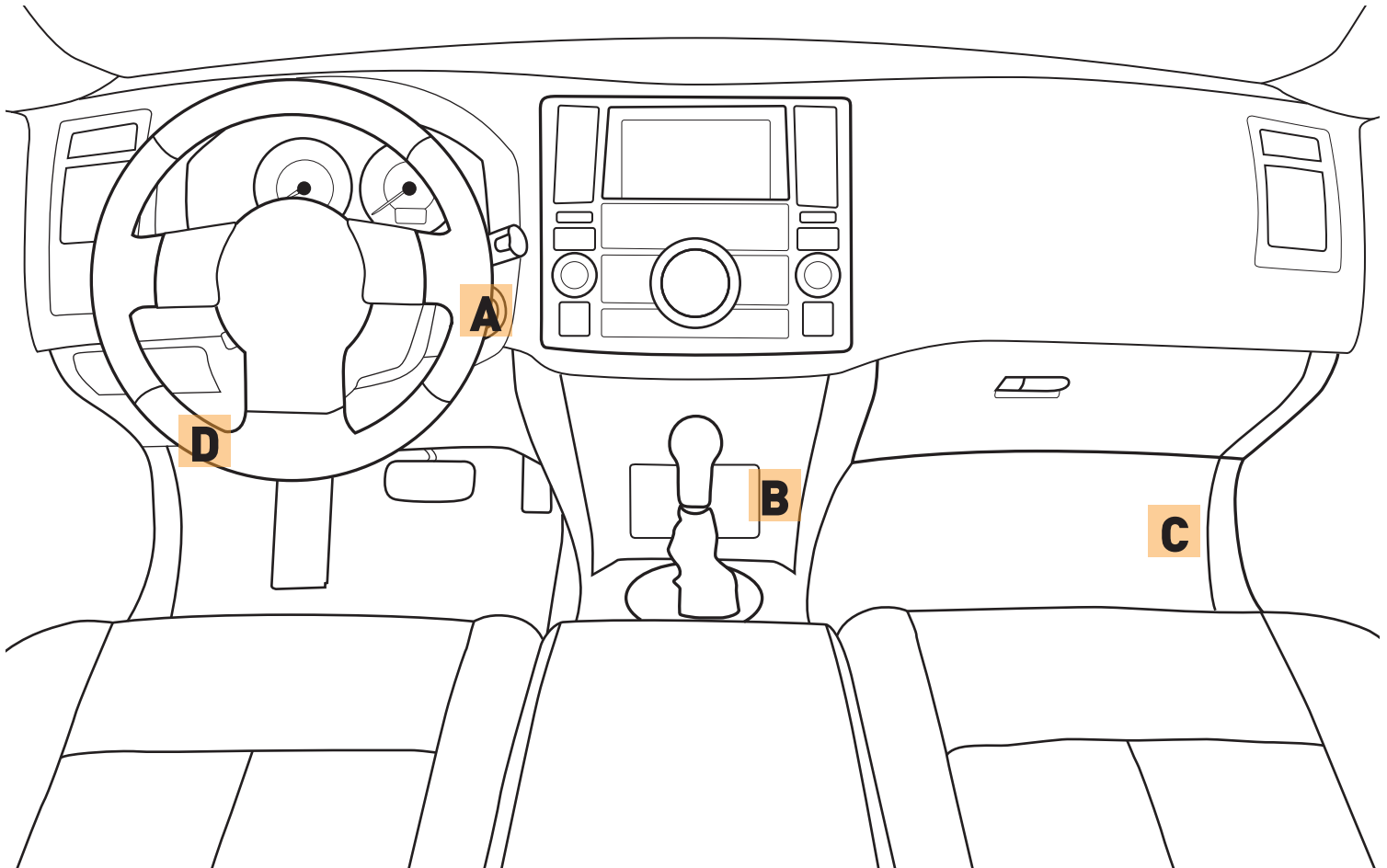

KNOWLEDGE BASE

HOW TO TEST THE “NEW GENERATION PASSLOCK” WIRE

The Passlock wire's voltage can vary according to the ignition's position. Although a small variation can occur when using a voltmeter, the Passlock wire should reflect the following results:

- On “Key sense”, the wire tests ± 12 VDC
- On “Accessory”, the wire tests ± 0 VDC
- With the ignition “ON”, the wire tests ± 4.0 VDC
- Upon start, the wire tests ± 3 VDC

When learning the module to the vehicle, consider the module have to read 20 identical voltage values on every key position before validating all the Passlock values. Give the module enough time into every key position to acquire its accurate sampling (follow the module LED reactions as found in the programming procedure).

WARNING!

The vehicles equipped with a new generation Passlock system usually don't have any (+) Start wire. The vehicle monitors the Passlock wire and the Accessory Power Drop while the ignition is ON to determine proper crank timing. Do not connect the remote starter (+) start wire to the vehicle.

ADVANCED DIAGNOSTIC (Available only on 32K, 64K and 128K microcontrollers)

Did you know the module will display its configuration information in the vehicle info center found in the instrument panel cluster or on the radio display. The module will automatically broadcast the information at the end of its learn sequence. You can also recall the information at any time by turning the key to the ON position and once the key is turned ON, press and hold down the programming button for 2 seconds and then release it.

The information displayed will be:

- Install Type
- PK3 Detected
- Passlock value at ignition
- Passlock value at start
- Keyless configuration
- Year matching VIN
- Auto Relock configuration

“NEW GENERATION” PASSLOCK/PK3+ TAMPER MODE

The new generation Passlock system is equipped with an anti theft countdown. When a failure to provide the vehicle the expected Passlock value, the vehicle will lock itself in Tamper Mode. Depending on various criteria, the vehicle BCM will evaluate the security breach and will decide if it locks itself in regular or “bad” Passlock tamper mode or in PK3 tamper mode.

PASSLOCK TAMPER MODE SYMPTOMS

The vehicle starts, ECM shuts off the fuel injectors and the security indicator starts blinking in the instrument panel cluster.

- To exit Passlock Tamper Mode, repair the failure in question.
- During the following steps, make sure the battery is fully charged (it is recommend to apply e-brake to turn off DTRL on Canadian vehicles).
- Turn the vehicle ignition ON, move the key to the START position and bring it back to the ON position before the car started.
- Leave the key to the ON position. The security indicator will start blinking.
- After 10 minutes, the security indicator will stop blinking, turn ON solid, then turn OFF.
- Turn the vehicle ignition to the OFF position, wait 15 seconds and then attempt to start the vehicle.
- If the vehicle starts, wait for the security indicator to turn OFF before you turn off the engine. If the vehicle fails to start, keep the ignition ON, you are in “BAD” Tamper mode and may have to repeat the entire sequence up to 3 times which may take over 30 minutes. There's no solution to get the vehicle out of Tamper Mode faster then waiting the required delays in each cycles.

PK3 TAMPER MODE SYMPTOMS

The vehicle doesn't start and the info center indicates a PK3+ failure.

- To exit PK3+ Tamper Mode, repair the failure in question.
- Close all vehicle doors
- Wait at least 3 minutes.
- Then start the vehicle using a valid key.
- The vehicle should start.
- If the vehicle refuses to start, unplug the vehicle battery for 30 seconds, then reconnect the battery and start the vehicle again. If the circuitry is properly connected and a valid key is used, the vehicle will start.

TYPE 1 - WIRE CROSS REFERENCE CHART

MAKE	MODEL	YEAR	WIRE DESCRIPTION	CONNECTOR			POSITION	WIRE COLOR	POLARITY	MODULE LOCATION	COMPONENT LOCATOR
				NAME	COLOR	TYPE					
CHEVROLET	Cobalt	05-06	Ignition	~	Green	6 pin	3	Pink or Yellow	(+)	Ignition switch	A
			Accessory	~	Green	6 pin	4	Brown	(+)	Ignition switch	A
			Passlock	~	Green	6 pin	5	White	~	Ignition switch	A
			12V	~	Green	6 pin	2	Red/White	(+)	Ignition switch	A
			12V	~	Black	5 pin	1	Red/White	(+)	PK3+	A
			Data (SWC)	OBDII	~	16 pin	1	Green	(DATA)	OBDII	D
			Data (Keyless)	C2	White	72 pin	12	Tan/White or LtGreen	(DATA)	BCM	B
	HHR	06	Ignition	~	Green	6 pin	3	Pink or Yellow	(+)	Ignition switch	A
			Accessory	~	Green	6 pin	4	Brown	(+)	Ignition switch	A
			Passlock	~	Green	6 pin	5	White	~	Ignition switch	A
			12V	~	Green	6 pin	2	Red/White	(+)	Ignition switch	A
			12V	~	Black	5 pin	1	Red/White	(+)	PK3+	A
			Data (SWC)	OBDII	~	16 pin	1	Green	(DATA)	OBDII	D
			Data (Keyless)	C2	White	72 pin	12	Tan/White or LtGreen	(DATA)	BCM	B
	Malibu Classic Malibu MAXX	04-07 04-06	Ignition	~	Green	6 pin	3	Pink or Yellow	(+)	Ignition switch	A
			Accessory	~	Green	6 pin	4	Brown	(+)	Ignition switch	A
			Passlock	~	Green	6 pin	5	White	~	Ignition switch	A
			12V	~	Green	6 pin	2	Red/White	(+)	Ignition switch	A
			12V	~	Black	5 pin	1	Red/White	(+)	PK3+	A
			Data (SWC)	OBDII	~	16 pin	1	Green	(DATA)	OBDII	D
			Data (Keyless)	C2	White	72 pin	12	Tan/White or LtGreen	(DATA)	BCM	B
PONTIAC	G6	05-06	Ignition	~	Green	6 pin	3	Pink or Yellow	(+)	Ignition switch	A
			Accessory	~	Green	6 pin	4	Brown	(+)	Ignition switch	A
			Passlock	~	Green	6 pin	5	White	~	Ignition switch	A
			12V	~	Green	6 pin	2	Red/White	(+)	Ignition switch	A
			12V	~	Black	5 pin	1	Red/White	(+)	PK3+	A
			Data (SWC)	OBDII	~	16 pin	1	Green	(DATA)	OBDII	D
			Data (Keyless)	C2	White	72 pin	12	Tan/White or LtGreen	(DATA)	BCM	B
	Pursuit / G5	05-06	Ignition	~	Green	6 pin	3	Pink or Yellow	(+)	Ignition switch	A
			Accessory	~	Green	6 pin	4	Brown	(+)	Ignition switch	A
			Passlock	~	Green	6 pin	5	White	~	Ignition switch	A
			12V	~	Green	6 pin	2	Red/White	(+)	Ignition switch	A
			12V	~	Black	5 pin	1	Red/White	(+)	PK3+	A
			Data (SWC)	OBDII	~	16 pin	1	Green	(DATA)	OBDII	D
			Data (Keyless)	C2	White	72 pin	12	Tan/White or LtGreen	(DATA)	BCM	B
	Solstice	06	Ignition	~	Green	6 pin	3	Pink or Yellow	(+)	Ignition switch	A
			Accessory	~	Green	6 pin	4	Brown	(+)	Ignition switch	A
			Passlock	~	Green	6 pin	5	White	~	Ignition switch	A
			12V	~	Green	6 pin	2	Red/White	(+)	Ignition switch	A
			12V	~	Black	5 pin	1	Red/White	(+)	PK3+	A
			Data (SWC)	OBDII	~	16 pin	1	Green	(DATA)	OBDII	D
			Data (Keyless)	C2	White	72 pin	12	Tan/White or LtGreen	(DATA)	BCM	C

TYPE 1 - WIRING DIAGRAM

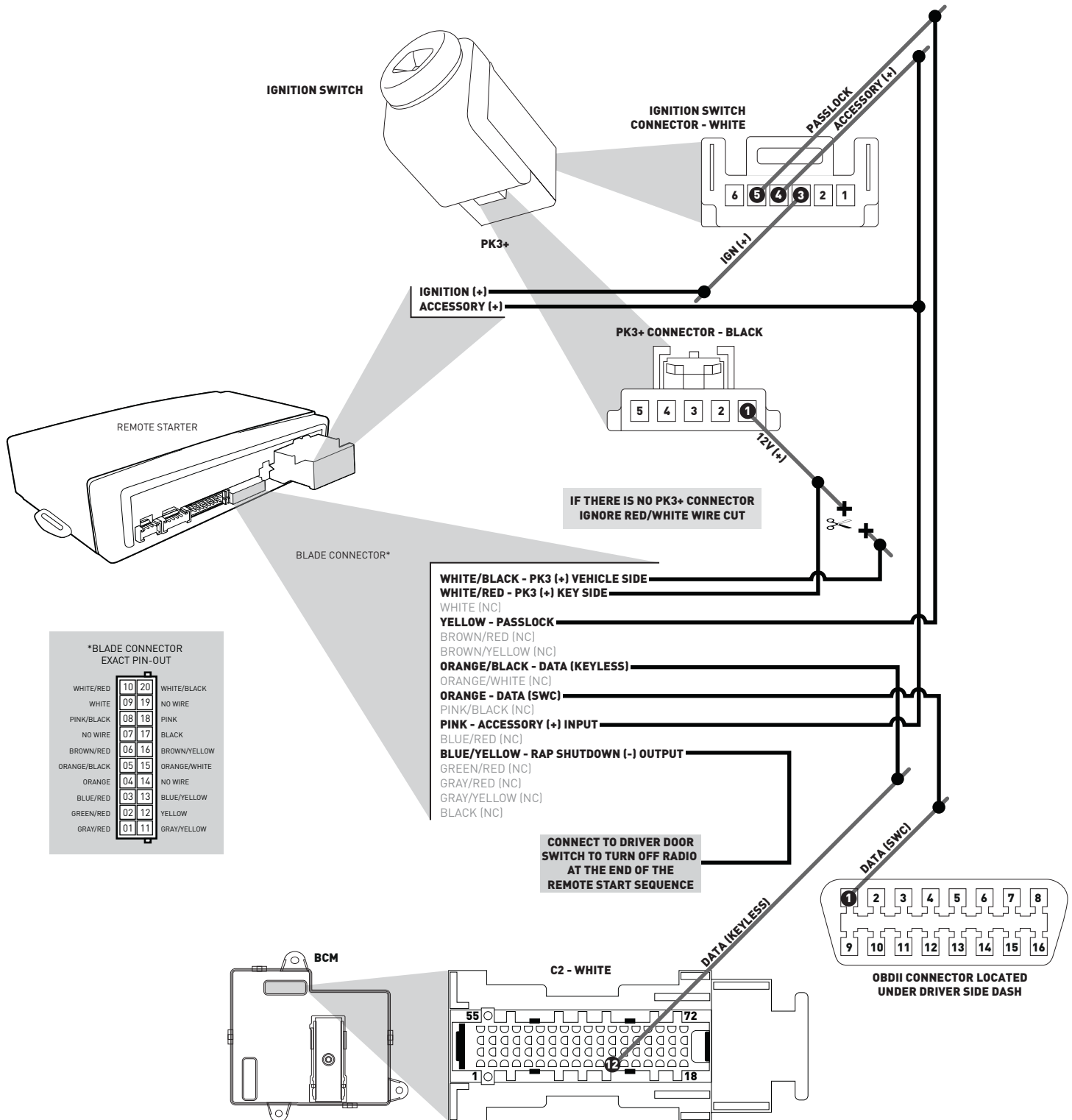

*BLADE CONNECTOR EXACT PIN-OUT

WHITE/RED	10	20	WHITE/BLACK
WHITE	09	19	NO WIRE
PINK/BLACK	08	18	PINK
NO WIRE	07	17	BLACK
BROWN/RED	06	16	BROWN/YELLOW
ORANGE/BLACK	05	15	ORANGE/WHITE
ORANGE	04	14	NO WIRE
BLUE/RED	03	13	BLUE/YELLOW
GREEN/RED	02	12	YELLOW
GRAY/RED	01	11	GRAY/YELLOW

TYPE 2 - WIRE CROSS REFERENCE CHART

MAKE	MODEL	YEAR	WIRE DESCRIPTION	CONNECTOR			POSITION	WIRE COLOR	POLARITY	MODULE LOCATION	COMPONENT LOCATOR
				NAME	COLOR	TYPE					
CHEVROLET	Cobalt	07-10	Ignition	~	Green	6 pin	3	Pink or Yellow	(+)	Ignition switch	A
			Accessory	~	Green	6 pin	4	Brown	(+)	Ignition switch	A
			Passlock	~	Green	6 pin	5	White	~	Ignition switch	A
			12V	~	Green	6 pin	2	Red/White	(+)	Ignition switch	A
			Data (SWC)	OBDII	~	16 pin	1	Green	(DATA)	OBDII	D
			Security Light	C2	White	72 pin	11	DkGreen	(DATA)	BCM	B
	HHR	07-11	Ignition	~	Green	6 pin	3	Pink or Yellow	(+)	Ignition switch	A
			Accessory	~	Green	6 pin	4	Brown	(+)	Ignition switch	A
			Passlock	~	Green	6 pin	5	White	~	Ignition switch	A
			12V	~	Green	6 pin	2	Red/White	(+)	Ignition switch	A
			Data (SWC)	OBDII	~	16 pin	1	Green	(DATA)	OBDII	D
			Security Light	C2	White	72 pin	11	DkGreen	(DATA)	BCM	B
	Malibu Malibu Hybrid Malibu MAXX	07-12 08-12 07-09	Ignition	~	Green	6 pin	3	Pink or Yellow	(+)	Ignition switch	A
			Accessory	~	Green	6 pin	4	Brown	(+)	Ignition switch	A
			Passlock	~	Green	6 pin	5	White	~	Ignition switch	A
			12V	~	Green	6 pin	2	Red/White	(+)	Ignition switch	A
			Data (SWC)	OBDII	~	16 pin	1	Green	(DATA)	OBDII	D
			Security Light	C2	White	72 pin	11	DkGreen	(DATA)	BCM	B
PONTIAC	G6	07-09	Ignition	~	Green	6 pin	3	Pink or Yellow	(+)	Ignition switch	A
			Accessory	~	Green	6 pin	4	Brown	(+)	Ignition switch	A
			Passlock	~	Green	6 pin	5	White	~	Ignition switch	A
			12V	~	Green	6 pin	2	Red/White	(+)	Ignition switch	A
			Data (SWC)	OBDII	~	16 pin	1	Green	(DATA)	OBDII	D
			Security Light	C2	White	72 pin	11	DkGreen	(DATA)	BCM	B
	Pursuit / G5	07-10	Ignition	~	Green	6 pin	3	Pink or Yellow	(+)	Ignition switch	A
			Accessory	~	Green	6 pin	4	Brown	(+)	Ignition switch	A
			Passlock	~	Green	6 pin	5	White	~	Ignition switch	A
			12V	~	Green	6 pin	2	Red/White	(+)	Ignition switch	A
			Data (SWC)	OBDII	~	16 pin	1	Green	(DATA)	OBDII	D
			Security Light	C2	White	72 pin	11	DkGreen	(DATA)	BCM	B
	Solstice	07-09	Ignition	~	Green	6 pin	3	Pink or Yellow	(+)	Ignition switch	A
			Accessory	~	Green	6 pin	4	Brown	(+)	Ignition switch	A
			Passlock	~	Green	6 pin	5	White	~	Ignition switch	A
			12V	~	Green	6 pin	2	Red/White	(+)	Ignition switch	A
			Data (SWC)	OBDII	~	16 pin	1	Green	(DATA)	OBDII	D
			Security Light	C2	White	72 pin	11	DkGreen	(DATA)	BCM	C

TYPE 2 - WIRE CROSS REFERENCE CHART

MAKE	MODEL	YEAR	WIRE DESCRIPTION	CONNECTOR			POSITION	WIRE COLOR	POLARITY	MODULE LOCATION	COMPONENT LOCATOR
				NAME	COLOR	TYPE					
SATURN	Aura / Hybrid	07-10	Ignition	~	Green	6 pin	3	Pink or Yellow	(+)	Ignition switch	A
			Accessory	~	Green	6 pin	4	Brown	(+)	Ignition switch	A
			Passlock	~	Green	6 pin	5	White	~	Ignition switch	A
			12V	~	Green	6 pin	2	Red/White	(+)	Ignition switch	A
			Data (SWC)	OBDII	~	16 pin	1	Green	(DATA)	OBDII	D
			Security Light	C2	White	72 pin	11	DkGreen	(DATA)	BCM	B
	Sky	07-09	Ignition	~	Green	6 pin	3	Pink or Yellow	(+)	Ignition switch	A
			Accessory	~	Green	6 pin	4	Brown	(+)	Ignition switch	A
			Passlock	~	Green	6 pin	5	White	~	Ignition switch	A
			12V	~	Green	6 pin	2	Red/White	(+)	Ignition switch	A
			Data (SWC)	OBDII	~	16 pin	1	Green	(DATA)	OBDII	D
			Security Light	C2	White	72 pin	11	DkGreen	(DATA)	BCM	C

TYPE 2 - WIRING DIAGRAM

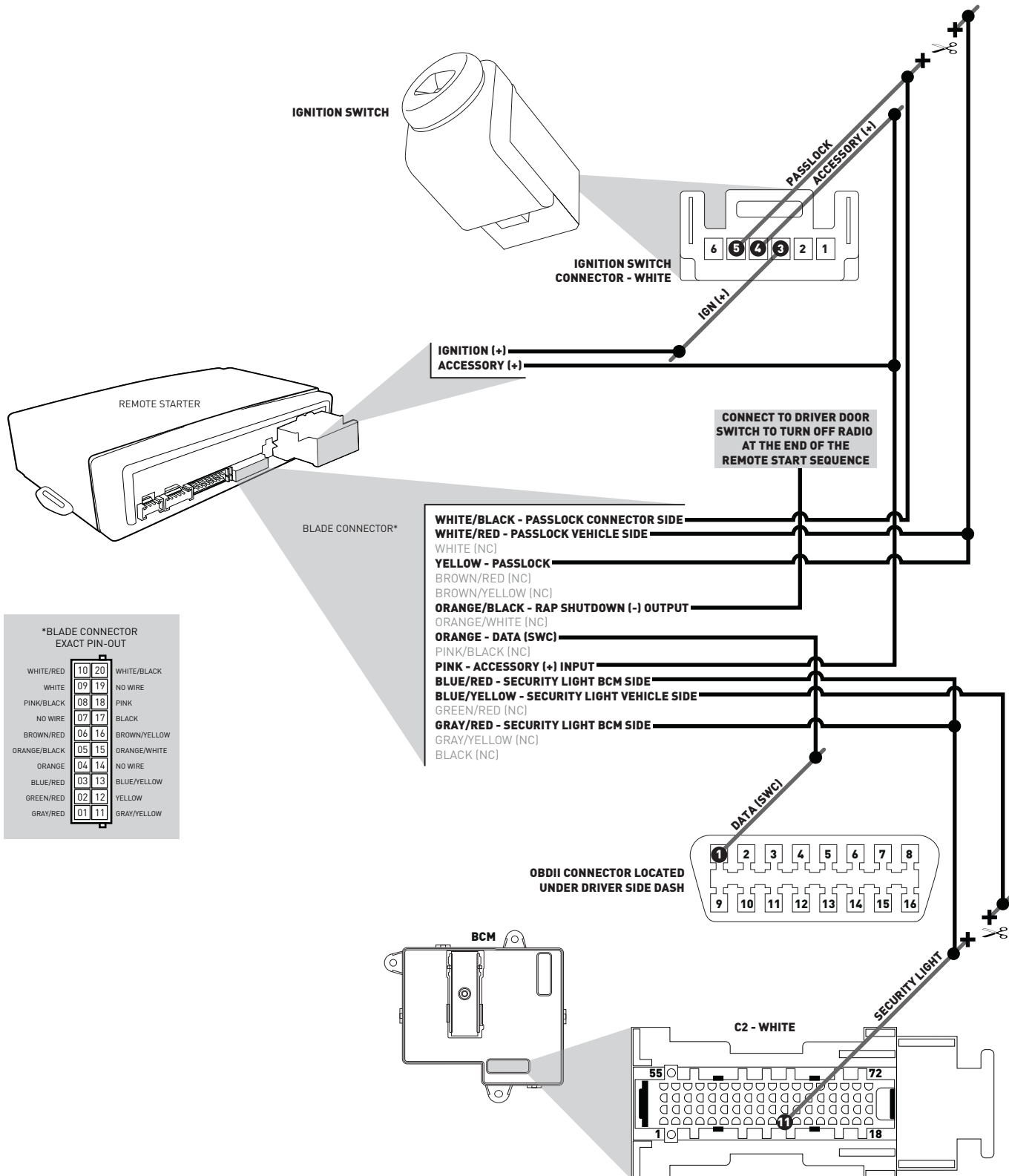

CARTRIDGE INSTALLATION

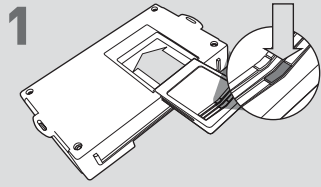

1 Slide cartridge into unit. Notice button under LED.

2

Ready for Module Programming Procedure.

MODULE PROGRAMMING PROCEDURE

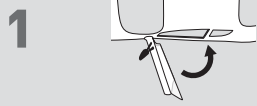

1 Close driver door.

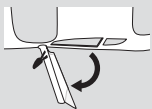

Re-open driver door to wake up data bus.

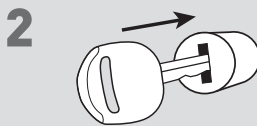

2 Insert key into ignition.

Wait **3 seconds**.



3 Turn key to Accessory position.

Wait **3 seconds**.



4 Turn key to ON position.

Wait **3 seconds**.



5 Turn key to Start position and Hold for **3 seconds**.



6 Release key from Start position and return to ON position.

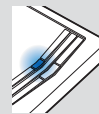

Wait, LED will turn solid BLUE for **2 seconds**.



7 Turn key to OFF position.

8

Module Programming Procedure completed.

IDENTIFY VEHICLE YEAR

1

Locate the Vehicle Identification Number (VIN) and identify the 10th character.



2

Match the VIN's 10th character to its corresponding year.

L → 1990	S → 1995	Y → 2000	5 → 2005	A → 2010
M → 1991	T → 1996	1 → 2001	6 → 2006	B → 2011
N → 1992	V → 1997	2 → 2002	7 → 2007	C → 2012
P → 1993	W → 1998	3 → 2003	8 → 2008	D → 2013
R → 1994	X → 1999	4 → 2004	9 → 2009	E → 2014

MODULE DIAGNOSTICS

LED STATUS	DIAGNOSTICS		
	DURING PROGRAMMING	DURING REMOTE START	WITH IGNITION OFF
Flashing RED	Missing/wrong information from firmware or vehicle	Incorrectly programmed	Incorrectly programmed or connected
Solid RED	Waiting for more vehicle information	Incorrectly programmed	Not programmed waiting for more vehicle information
Flashing BLUE	Additional steps required to complete programming	Correctly programmed and operational	False ground when running status from remote starter
Solid BLUE then OFF	Correctly programmed	Reset in progress	Reset in progress
OFF	No activity or already programmed	Invalid ground when running status from remote starter	At rest and ready for a remote start sequence

FACTORY RESET PROCEDURE

1

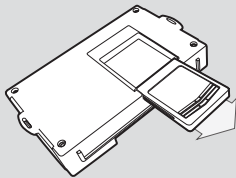

DISCONNECT cartridge from remote starter.

2

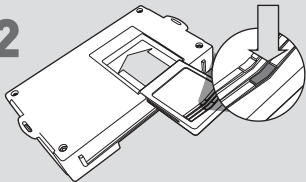

PRESS AND HOLD programming button while re-connecting cartridge to remote starter.

3

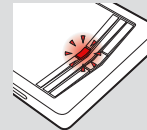

LED will flash red. Immediately **RELEASE** programming button.

4

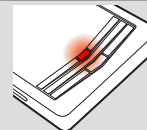

LED will turn solid red for 2 seconds.

RESET COMPLETED.

5

RECONNECT all connectors. Repeat programming procedure.



Failure to follow procedure may result with a DTC or a CHECK ENGINE error message.