

BLADE

SERIES

Automotive Data Solutions Inc.

INSTALL GUIDE

BLADE-AL(DL)-GM10-EN

GM10

AVAILABLE FOR: ADS-BLADE AL

Rev. Date: November 30, 2012

Doc. No.: ##10192##

20121130

VERSION FRANÇAISE DISPONIBLE EN LIGNE AU WWW.BLADEUPDATE.COM

PLEASE VISIT WWW.BLADEUPDATE.COM FOR COMPLETE PRODUCT DETAILS

The brand names and logos found in this guide are property of their respective owners. Automotive Data Solutions Inc. © 2012

PONTIAC. CHEVROLET BUICK

 SATURN® GMC *Cadillac*

NOTICE: The manufacturer will accept no responsibility for any electrical damage resulting from improper installation of this product, be that either damage to the vehicle itself or to the installed device. This device must be installed by a certified technician. This guide has been written for properly trained technicians; a certain level of skill & knowledge is therefore assumed. Please review the Installation Guide carefully before beginning any work.

INSTALL TYPE SELECTION - 1 OF 2

MAKE	MODEL	YEAR	INSTALL TYPE	FEATURES																
				DATA IMMOBILIZER BYPASS	ARM OEM ALARM	DISARM OEM ALARM	DOOR LOCK	DOOR UNLOCK	PRIORITY UNLOCK	TRUNK/HATCH RELEASE*	TAILGATE WINDOW RELEASE	HEATED SEATS CTRL	PUDDLE LIGHT CTRL**	TACHOMETER OUTPUT	DOOR STAT OUTPUT	HOOD STAT OUTPUT*	TRUNK STAT OUTPUT	BRAKE PEDAL STAT OUTPUT	E-BRAKE OUTPUT	RAP SHUTDOWN CTRL
BUICK	Enclave Regular key	08-13	1	•	•	•	•	•	•	•	•	•	•	•	•	•	•	•	•	•
	Lucerne Regular key	06-11	2	•	•	•	•	•	•	•	•	•	•	•	•	•	•	•	•	•
CADILLAC	CTS Regular key	08-11	1	•	•	•	•	•	•	•	•	•	•	•	•	•	•	•	•	•
	DTS Regular key	06-11	2	•	•	•	•	•	•	•	•	•	•	•	•	•	•	•	•	•
	Escalade / ESV / Hybrid Regular key	07-13	3	•	•	•	•	•	•	•	•	•	•	•	•	•	•	•	•	•
	Escalade EXT Regular key	07-13	3	•	•	•	•	•	•	•	•	•	•	•	•	•	•	•	•	•
	SRX Regular key	07-10	3	•	•	•	•	•	•	•	•	•	•	•	•	•	•	•	•	•
CHEVROLET	Avalanche Regular key	07-13	3	•	•	•	•	•	•	•	•	•	•	•	•	•	•	•	•	•
	Equinox Regular key	07-09	2	•	•	•	•	•	•	•	•	•	•	•	•	•	•	•	•	•
	Express Regular key	08-13	3	•	•	•	•	•	•	•	•	•	•	•	•	•	•	•	•	•
	Impala Regular key	06-13	2	•	•	•	•	•	•	•	•	•	•	•	•	•	•	•	•	•
	Monte Carlo Regular key	06-09	2	•	•	•	•	•	•	•	•	•	•	•	•	•	•	•	•	•
	Silverado / Hybrid Regular key	07-13	3	•	•	•	•	•	•	•	•	•	•	•	•	•	•	•	•	•
	Silverado / Hybrid Premium Package Regular key	07-13	3	•	•	•	•	•	•	•	•	•	•	•	•	•	•	•	•	•
	Suburban Regular key	07-13	2	•	•	•	•	•	•	•	•	•	•	•	•	•	•	•	•	•
	Tahoe / Hybrid Regular key	07-13	3	•	•	•	•	•	•	•	•	•	•	•	•	•	•	•	•	•
	Traverse Regular key	09-13	1	•	•	•	•	•	•	•	•	•	•	•	•	•	•	•	•	•
	Traverse with Auto Up/Down Windows Regular key	09-13	1	•	•	•	•	•	•	•	•	•	•	•	•	•	•	•	•	•
GMC	Acadia Regular key	07-13	1	•	•	•	•	•	•	•	•	•	•	•	•	•	•	•	•	•
	Acadia with Auto Up/Down Windows Regular key	07-13	1	•	•	•	•	•	•	•	•	•	•	•	•	•	•	•	•	•
	Savana Regular key	08-13	3	•	•	•	•	•	•	•	•	•	•	•	•	•	•	•	•	•
	Sierra Regular key	07-13	3	•	•	•	•	•	•	•	•	•	•	•	•	•	•	•	•	•
	Sierra Premium Package Regular key	07-13	3	•	•	•	•	•	•	•	•	•	•	•	•	•	•	•	•	•
	Yukon / XL / Denali / Hybrid Regular key	07-13	3	•	•	•	•	•	•	•	•	•	•	•	•	•	•	•	•	•
HUMMER	H2 Regular key	08-09	3	•	•	•	•	•	•	•	•	•	•	•	•	•	•	•	•	•

* If equipped

** If activated in vehicle settings

INSTALL TYPE SELECTION - 2 OF 2

MAKE	MODEL	YEAR	INSTALL TYPE	FEATURES																		
				DATA IMMOBILIZER BYPASS	ARM OEM ALARM	DISARM OEM ALARM	DOOR LOCK	DOOR UNLOCK	PRIORITY UNLOCK	TRUNK/HATCH RELEASE*	TAILGATE WINDOW RELEASE	HEATED SEATS CTRL	PUDDLE LIGHT CTRL**	TACHOMETER OUTPUT	DOOR STAT OUTPUT	HOOD STAT OUTPUT*	TRUNK STAT OUTPUT	BRAKE PEDAL STAT OUTPUT	E-BRAKE OUTPUT	RAP SHUTDOWN CTRL		
PONTIAC	G8 Regular key	08-09	2	•	•	•	•	•	•	•	•				•	•	•	•	•	•		
	Torrent Regular key	07-09	2	•	•	•	•	•	•						•	•	•	•	•	•	•	
SATURN	Outlook Regular key	07-10	1	•	•	•	•	•	•						•	•	•	•	•	•	•	•
	Outlook with Auto Up/Down Windows Regular key	07-10	1	•	•	•	•	•	•						•	•	•	•	•	•	•	•
	Vue / Hybrid Regular key	08-10	2	•	•	•	•	•	•						•	•	•	•	•	•	•	•
SUZUKI	XL7 Regular key	07-09	2	•	•	•	•	•	•						•	•	•	•	•	•	•	•

* If equipped

** If activated in vehicle settings

TYPE 1 - WIRE CROSS REFERENCE CHART - 1 OF 1

MAKE	MODEL	YEAR	WIRE DESCRIPTION	CONNECTOR			POSITION	WIRE COLOR	POLARITY	LOCATION	COMPONENT LOCATOR
				NAME	COLOR	TYPE					
BUICK	Enclave	08-13	Passlock	~	~	6 pin	5	White	(+)	Ignition connector	~
			Ignition	~	~	6 pin	1	Pink	(+)	Ignition connector	~
			PK3 12V (10AMP)	~	~	5 pin	1	Red/White	(+)	PK3+ connector	~
			Accessory	~	~	5 pin	2	Brown	(+)	PK3+ connector	~
			Ground	~	~	5 pin	3	Black/White	(-)	PK3+ connector	~
			SWC	~	~	5 pin	5	Green	[DATA]	PK3+ connector	~
CADILLAC	CTS	08-11	Passlock	~	~	6 pin	5	White	(+)	Ignition connector	~
			Ignition	~	~	6 pin	1	Pink	(+)	Ignition connector	~
			PK3 12V (10AMP)	~	~	5 pin	1	Orange	(+)	PK3+ connector	~
			Accessory	~	~	5 pin	2	Brown	(+)	PK3+ connector	~
			Ground	~	~	5 pin	3	Black/White	(-)	PK3+ connector	~
			SWC	~	~	5 pin	5	Green	[DATA]	PK3+ connector	~
CHEVROLET	Traverse	09-13	Passlock	~	~	6 pin	5	White	(+)	Ignition connector	~
			Ignition	~	~	6 pin	1	Pink	(+)	Ignition connector	~
			PK3 12V (10AMP)	~	~	5 pin	1	Red/White	(+)	PK3+ connector	~
			Accessory	~	~	5 pin	2	Brown	(+)	PK3+ connector	~
			Ground	~	~	5 pin	3	Black/White	(-)	PK3+ connector	~
			SWC	~	~	5 pin	5	Green	[DATA]	PK3+ connector	~
GMC	Acadia	07-13	Passlock	~	~	6 pin	5	White	(+)	Ignition connector	~
			Ignition	~	~	6 pin	1	Pink	(+)	Ignition connector	~
			PK3 12V (10AMP)	~	~	5 pin	1	Red/White	(+)	PK3+ connector	~
			Accessory	~	~	5 pin	2	Brown	(+)	PK3+ connector	~
			Ground	~	~	5 pin	3	Black/White	(-)	PK3+ connector	~
			SWC	~	~	5 pin	5	Green	[DATA]	PK3+ connector	~
SATURN	Outlook	07-10	Passlock	~	~	6 pin	5	White	(+)	Ignition connector	~
			Ignition	~	~	6 pin	1	Pink	(+)	Ignition connector	~
			PK3 12V (10AMP)	~	~	5 pin	1	Red/White	(+)	PK3+ connector	~
			Accessory	~	~	5 pin	2	Brown	(+)	PK3+ connector	~
			Ground	~	~	5 pin	3	Black/White	(-)	PK3+ connector	~
			SWC	~	~	5 pin	5	Green	[DATA]	PK3+ connector	~

TYPE 1 - WIRING DIAGRAM

NOTE
MODULE CONTROLS MULTIPLEX CIRCUIT BY DATA,
NO ADDITIONAL RELAYS OR RESISTORS REQUIRED.

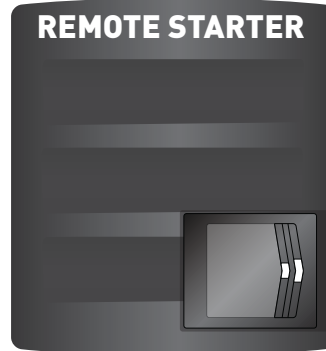

*BLADE CONNECTOR
EXACT PIN-OUT

WHITE/RED	10	20	WHITE/BLACK
WHITE	09	19	NO WIRE
PINK/BLACK	08	18	PINK
NO WIRE	07	17	BLACK
BROWN/RED	06	16	BROWN/YELLOW
ORANGE/BLACK	05	15	ORANGE/WHITE
ORANGE	04	14	NO WIRE
BLUE/RED	03	13	BLUE/YELLOW
GREEN/RED	02	12	YELLOW
GRAY/RED	01	11	GRAY/YELLOW

WHITE/BLACK - PK3 12V (+) CONNECTOR SIDE

WHITE/RED - PK3 12V (+) VEHICLE SIDE

WHITE (NC)
YELLOW - PASSLOCK
 BROWN/RED (NC)
 BROWN/YELLOW (NC)
 ORANGE/BLACK (NC)
 ORANGE/WHITE (NC)
ORANGE - DATA (SWC)
 PINK/BLACK (NC)
PINK - ACCESSORY (+) INPUT
 BLUE/RED (NC)
 BLUE/YELLOW (NC)
 GREEN/RED (NC)
 GRAY/RED (NC)
 GRAY/YELLOW (NC)
 BLACK (NC)

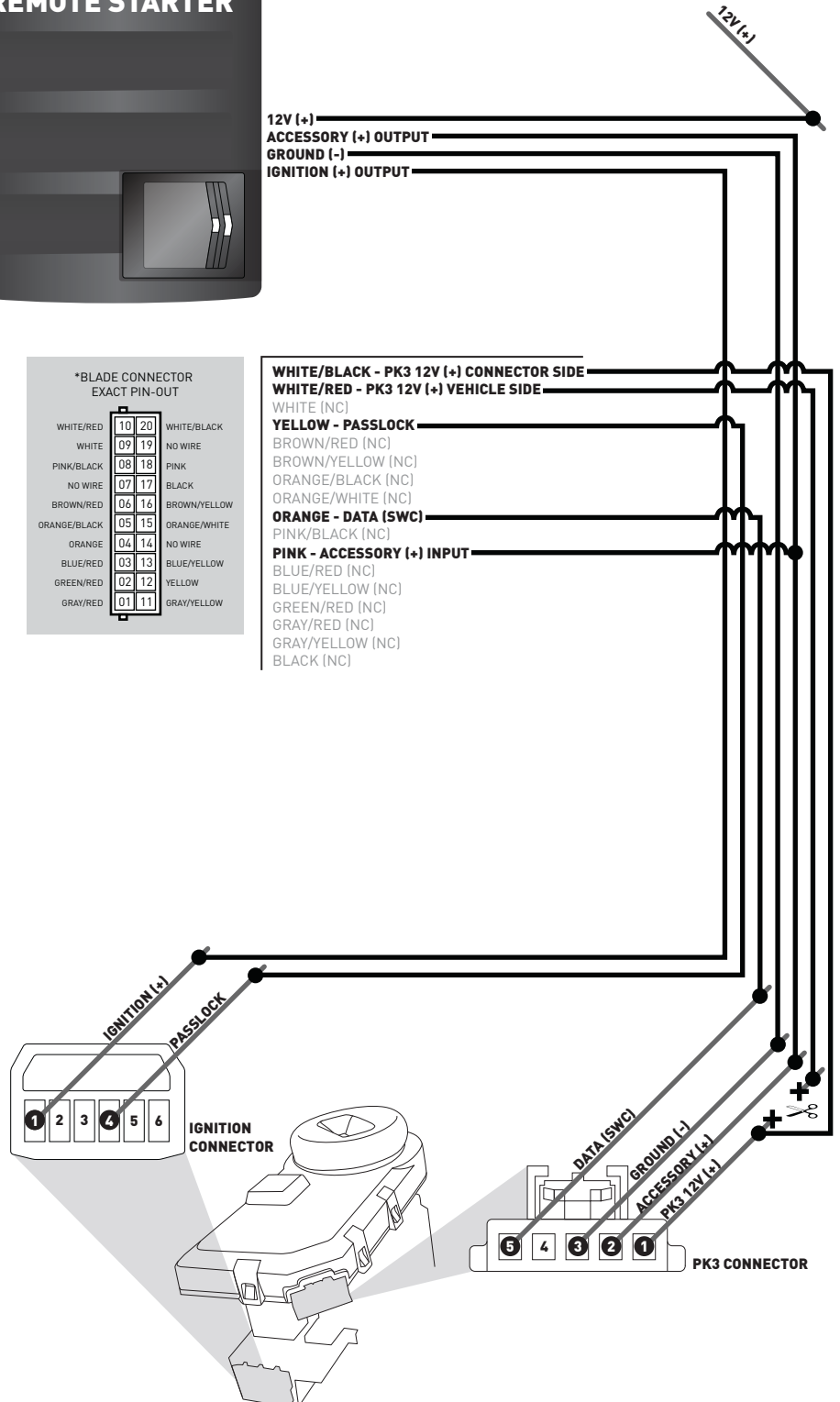

TYPE 2 - WIRE CROSS REFERENCE CHART - 1 OF 2

MAKE	MODEL	YEAR	WIRE DESCRIPTION	CONNECTOR			POSITION	WIRE COLOR	POLARITY	LOCATION	COMPONENT LOCATOR
				NAME	COLOR	TYPE					
BUICK	Lucerne	06-11	Passlock	~	~	6 pin	5	White	(+)	Ignition connector	~
			Ignition	~	~	6 pin	1	Pink	(+)	Ignition connector	~
			PK3 12V (10AMP)	~	~	5 pin	1	Orange	(+)	PK3+ connector	~
			Accessory	~	~	5 pin	2	Brown	(+)	PK3+ connector	~
			Ground	~	~	5 pin	3	Black	(-)	PK3+ connector	~
			SWC	~	~	5 pin	5	Green	[DATA]	PK3+ connector	~
CADILLAC	DTS	06-11	Passlock	~	~	6 pin	5	White	(+)	Ignition connector	~
			Ignition	~	~	6 pin	1	Pink	(+)	Ignition connector	~
			PK3 12V (10AMP)	~	~	5 pin	1	Orange	(+)	PK3+ connector	~
			Accessory	~	~	5 pin	2	Brown	(+)	PK3+ connector	~
			Ground	~	~	5 pin	3	Black	(-)	PK3+ connector	~
			SWC	~	~	5 pin	5	Green	[DATA]	PK3+ connector	~
CHEVROLET	Equinox	07-09	Passlock	~	~	6 pin	5	White	(+)	Ignition connector	~
			Ignition	~	~	6 pin	1	Pink	(+)	Ignition connector	~
			PK3 12V (10AMP)	~	~	5 pin	1	Red/White	(+)	PK3+ connector	~
			Accessory	~	~	5 pin	2	Brown	(+)	PK3+ connector	~
			Ground	~	~	5 pin	3	Black/White	(-)	PK3+ connector	~
			SWC	~	~	5 pin	5	Green	[DATA]	PK3+ connector	~
	Impala	06-13	Passlock	~	~	6 pin	5	White	(+)	Ignition connector	~
			Ignition	~	~	6 pin	1	Pink	(+)	Ignition connector	~
			PK3 12V (10AMP)	~	~	5 pin	1	Red/White	(+)	PK3+ connector	~
			Accessory	~	~	5 pin	2	Brown	(+)	PK3+ connector	~
			Ground	~	~	5 pin	3	Black/White	(-)	PK3+ connector	~
			SWC	~	~	5 pin	5	Green	[DATA]	PK3+ connector	~
	Monte Carlo	06-09	Passlock	~	~	6 pin	5	White	(+)	Ignition connector	~
			Ignition	~	~	6 pin	1	Pink	(+)	Ignition connector	~
			PK3 12V (10AMP)	~	~	5 pin	1	Red/White	(+)	PK3+ connector	~
			Accessory	~	~	5 pin	2	Brown	(+)	PK3+ connector	~
			Ground	~	~	5 pin	3	Black/White	(-)	PK3+ connector	~
			SWC	~	~	5 pin	5	Green	[DATA]	PK3+ connector	~
Suburban	07-13	Passlock	~	~	6 pin	5	Pink/Black	(+)	Ignition connector	~	
		Ignition	~	~	6 pin	1	Pink	(+)	Ignition connector	~	
		PK3 12V (10AMP)	~	~	5 pin	1	Red/White	(+)	PK3+ connector	~	
		Accessory	~	~	5 pin	2	Brown	(+)	PK3+ connector	~	
		Ground	~	~	5 pin	3	Black/White	(-)	PK3+ connector	~	
		SWC	~	~	5 pin	5	Green	[DATA]	PK3+ connector	~	
PONTIAC	G8	08-09	Passlock	~	~	6 pin	6	White/Black	(+)	Ignition connector	~
			Ignition	~	~	6 pin	1	Pink	(+)	Ignition connector	~
			PK3 12V (10AMP)	~	~	5 pin	1	Orange/Black	(+)	PK3+ connector	~
			Accessory	~	~	5 pin	2	Brown	(+)	PK3+ connector	~
			Ground	~	~	5 pin	3	Black	(-)	PK3+ connector	~
			SWC	~	~	5 pin	5	Green	[DATA]	PK3+ connector	~

TYPE 2 - WIRE CROSS REFERENCE CHART - 2 OF 2

MAKE	MODEL	YEAR	WIRE DESCRIPTION	CONNECTOR			POSITION	WIRE COLOR	POLARITY	LOCATION	COMPONENT LOCATOR
				NAME	COLOR	TYPE					
PONTIAC	Torrent	07-09	Passlock	~	~	6 pin	5	White	(+)	Ignition connector	~
			Ignition	~	~	6 pin	1	Pink	(+)	Ignition connector	~
			PK3 12V (10AMP)	~	~	5 pin	1	Red/White	(+)	PK3+ connector	~
			Accessory	~	~	5 pin	2	Brown	(+)	PK3+ connector	~
			Ground	~	~	5 pin	3	Black/White	(-)	PK3+ connector	~
			SWC	~	~	5 pin	5	Green	[DATA]	PK3+ connector	~
SATURN	Vue	08-10	Passlock	~	~	6 pin	5	White/Black	(+)	Ignition connector	~
			Ignition	~	~	6 pin	1	Pink	(+)	Ignition connector	~
			PK3 12V (10AMP)	~	~	5 pin	1	~	(+)	PK3+ connector	~
			Accessory	~	~	5 pin	2	Brown	(+)	PK3+ connector	~
			Ground	~	~	5 pin	3	~	(-)	PK3+ connector	~
			SWC	~	~	5 pin	5	Green	[DATA]	PK3+ connector	~
SUZUKI	XL7	07-09	Passlock	~	~	6 pin	5	White	(+)	Ignition connector	~
			Ignition	~	~	6 pin	1	Pink	(+)	Ignition connector	~
			PK3 12V (10AMP)	~	~	5 pin	1	Red/White	(+)	PK3+ connector	~
			Accessory	~	~	5 pin	2	Brown	(+)	PK3+ connector	~
			Ground	~	~	5 pin	3	Black/White	(-)	PK3+ connector	~
			SWC	~	~	5 pin	5	Green	[DATA]	PK3+ connector	~

TYPE 2 - WIRING DIAGRAM

NOTE
MODULE CONTROLS MULTIPLEX CIRCUIT BY DATA, 3 DATA,
NO ADDITIONAL RELAYS OR RESISTORS REQUIRED. REQUIS.

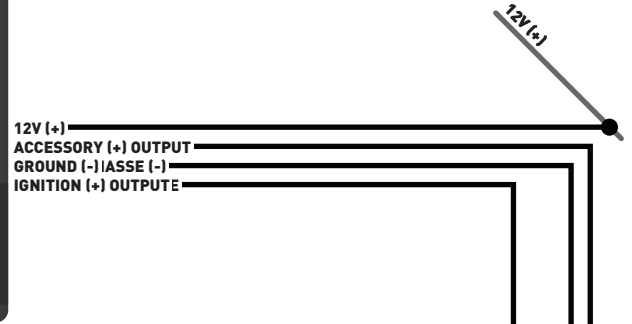

*BLADE CONNECTOR EXACT PIN-OUT

WHITE/RED	10	20	WHITE/BLACK
WHITE	09	19	NO WIRE
PINK/BLACK	08	18	PINK
NO WIRE	07	17	BLACK
BROWN/RED	06	16	BROWN/YELLOW
ORANGE/BLACK	05	15	ORANGE/WHITE
ORANGE	04	14	NO WIRE
BLUE/RED	03	13	BLUE/YELLOW
GREEN/RED	02	12	YELLOW
GRAY/RED	01	11	GRAY/YELLOW

- WHITE/BLACK - PK3 12V (+) CONNECTOR SIDE
- WHITE/RED - PK3 12V (+) VEHICLE SIDE
- WHITE (NC)
- YELLOW - PASSLOCK
- BROWN/RED (NC)
- BROWN/YELLOW (NC)
- ORANGE/BLACK (NC)
- ORANGE/WHITE (NC)
- ORANGE - DATA (SWC)
- PINK/BLACK (NC)
- PINK - ACCESSORY (+) INPUT
- BLUE/RED (NC)
- BLUE/YELLOW (NC)
- GREEN/RED (NC)
- GRAY/RED (NC)
- GRAY/YELLOW (NC)
- BLACK (NC)

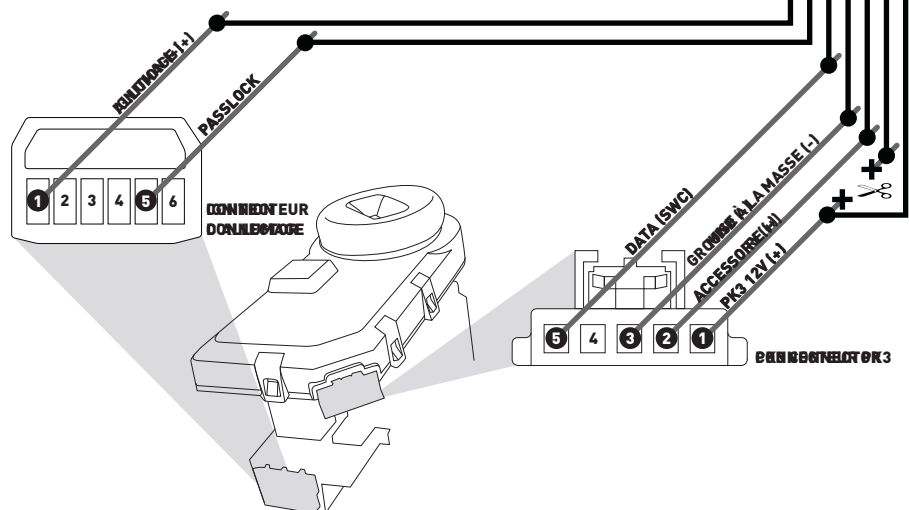

TYPE 3 - WIRE CROSS REFERENCE CHART - 1 OF 2

MAKE	MODEL	YEAR	WIRE DESCRIPTION	CONNECTOR			POSITION	WIRE COLOR	POLARITY	LOCATION	COMPONENT LOCATOR
				NAME	COLOR	TYPE					
CADILLAC	Escalade	07-13	Passlock	~	~	6 pin	5	Pink/Black	(+)	Ignition connector	~
			Ignition	~	~	6 pin	1	Pink	(+)	Ignition connector	~
			PK3 12V (10AMP)	~	~	5 pin	1	Red/White	(+)	PK3+ connector	~
			Accessory	~	~	5 pin	2	Brown	(+)	PK3+ connector	~
			Ground	~	~	5 pin	3	Black/White	(-)	PK3+ connector	~
			SWC	~	~	5 pin	5	Green	[DATA]	PK3+ connector	~
	SRX	07-10	Passlock	~	~	6 pin	5	White	(+)	Ignition connector	~
			Ignition	~	~	6 pin	1	Pink	(+)	Ignition connector	~
			PK3 12V (10AMP)	~	~	5 pin	1	Red/White	(+)	PK3+ connector	~
			Accessory	~	~	5 pin	2	Brown	(+)	PK3+ connector	~
			Ground	~	~	5 pin	3	Black/White	(-)	PK3+ connector	~
			SWC	~	~	5 pin	5	Green	[DATA]	PK3+ connector	~
CHEVROLET	Avalanche	07-13	Passlock	~	~	6 pin	5	Pink/Black	~	Ignition connector	~
			Ignition	~	~	6 pin	1	Pink	~	Ignition connector	~
			PK3 12V (10AMP)	~	~	5 pin	1	Red/White	(+)	PK3+ connector	~
			Accessory	~	~	5 pin	2	Brown	(+)	PK3+ connector	~
			Ground	~	~	5 pin	3	Black/White	(-)	PK3+ connector	~
			SWC	~	~	5 pin	5	Green	~	PK3+ connector	~
	Express	08-13	Passlock	~	~	6 pin	5	Pink	(+)	Ignition connector	~
			Ignition	~	~	6 pin	1	Pink	(+)	Ignition connector	~
			PK3 12V (10AMP)	~	~	5 pin	1	Orange	(+)	PK3+ connector	~
			Accessory	~	~	5 pin	2	Brown	(+)	PK3+ connector	~
			Ground	~	~	5 pin	3	Black/White	(-)	PK3+ connector	~
			SWC	~	~	5 pin	5	Green	[DATA]	PK3+ connector	~
	Silverado	07-13	Passlock	~	~	6 pin	5	Pink/Black	(+)	Ignition connector	~
			Ignition	~	~	6 pin	1	Pink	(+)	Ignition connector	~
			PK3 12V (10AMP)	~	~	5 pin	1	Red/White	(+)	PK3+ connector	~
			Accessory	~	~	5 pin	2	Brown	(+)	PK3+ connector	~
			Ground	~	~	5 pin	3	Black/White	(-)	PK3+ connector	~
			SWC	~	~	5 pin	5	Green	[DATA]	PK3+ connector	~
	Tahoe	07-13	Passlock	~	~	6 pin	5	Pink/Black	(+)	Ignition connector	~
			Ignition	~	~	6 pin	1	Pink	(+)	Ignition connector	~
			PK3 12V (10AMP)	~	~	5 pin	1	Red/White	(+)	PK3+ connector	~
			Accessory	~	~	5 pin	2	Brown	(+)	PK3+ connector	~
			Ground	~	~	5 pin	3	Black/White	(-)	PK3+ connector	~
			SWC	~	~	5 pin	5	Green	[DATA]	PK3+ connector	~
GMC	Savana	08-13	Passlock	~	~	6 pin	5	Pink	(+)	Ignition connector	~
			Ignition	~	~	6 pin	1	Pink	(+)	Ignition connector	~
			PK3 12V (10AMP)	~	~	5 pin	1	Orange	(+)	PK3+ connector	~
			Accessory	~	~	5 pin	2	Brown	(+)	PK3+ connector	~
			Ground	~	~	5 pin	3	Black/White	(-)	PK3+ connector	~
			SWC	~	~	5 pin	5	Green	[DATA]	PK3+ connector	~

TYPE 3 - WIRE CROSS REFERENCE CHART - 2 OF 2

MAKE	MODEL	YEAR	WIRE DESCRIPTION	CONNECTOR			POSITION	WIRE COLOR	POLARITY	LOCATION	COMPONENT LOCATOR
				NAME	COLOR	TYPE					
GMC	Sierra	07-13	Passlock	~	~	6 pin	5	Pink/Black	(+)	Ignition connector	~
			Ignition	~	~	6 pin	1	Pink	(+)	Ignition connector	~
			PK3 12V (10AMP)	~	~	5 pin	1	Red/White	(+)	PK3+ connector	~
			Accessory	~	~	5 pin	2	Brown	(+)	PK3+ connector	~
			Ground	~	~	5 pin	3	Black/White	(-)	PK3+ connector	~
			SWC	~	~	5 pin	5	Green	[DATA]	PK3+ connector	~
	Yukon	07-13	Passlock	~	~	6 pin	5	Pink/Black	(+)	Ignition connector	~
			Ignition	~	~	6 pin	1	Pink	(+)	Ignition connector	~
			PK3 12V (10AMP)	~	~	5 pin	1	Red/White	(+)	PK3+ connector	~
			Accessory	~	~	5 pin	2	Brown	(+)	PK3+ connector	~
			Ground	~	~	5 pin	3	Black/White	(-)	PK3+ connector	~
			SWC	~	~	5 pin	5	Green	[DATA]	PK3+ connector	~
HUMMER	H2	08-09	Passlock	~	~	6 pin	5	Pink/Black	(+)	Ignition connector	~
			Ignition	~	~	6 pin	1	Pink	(+)	Ignition connector	~
			PK3 12V (10AMP)	~	~	5 pin	1	Red/White	(+)	PK3+ connector	~
			Accessory	~	~	5 pin	2	Brown	(+)	PK3+ connector	~
			Ground	~	~	5 pin	3	Black/White	(-)	PK3+ connector	~
			SWC	~	~	5 pin	5	Green	[DATA]	PK3+ connector	~

TYPE 3 - WIRING DIAGRAM

NOTE
MODULE CONTROLS MULTIPLEX CIRCUIT BY DATA, 3 DATA,
NO ADDITIONAL RELAYS OR RESISTORS REQUIRED. REQUIS.

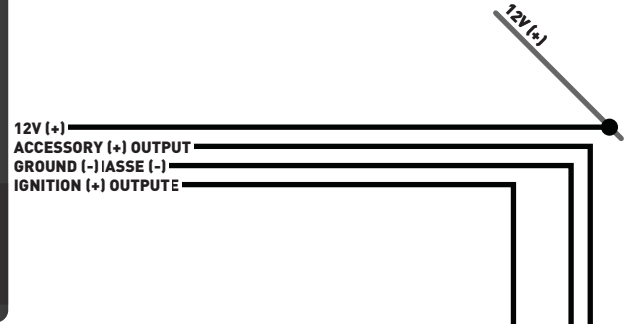

***BLADE CONNECTOR EXACT PIN-OUT**

WHITE/RED	10	20	WHITE/BLACK
WHITE	09	19	NO WIRE
PINK/BLACK	08	18	PINK
NO WIRE	07	17	BLACK
BROWN/RED	06	16	BROWN/YELLOW
ORANGE/BLACK	05	15	ORANGE/WHITE
ORANGE	04	14	NO WIRE
BLUE/RED	03	13	BLUE/YELLOW
GREEN/RED	02	12	YELLOW
GRAY/RED	01	11	GRAY/YELLOW

- WHITE/BLACK - PK3 12V (+) CONNECTOR SIDE
- WHITE/RED - PK3 12V (+) VEHICLE SIDE
- WHITE (NC)
- YELLOW - PASSLOCK
- BROWN/RED (NC)
- BROWN/YELLOW (NC)
- ORANGE/BLACK (NC)
- ORANGE/WHITE (NC)
- ORANGE - DATA (SWC)
- PINK/BLACK (NC)
- PINK - ACCESSORY (+) INPUT
- BLUE/RED (NC)
- BLUE/YELLOW (NC)
- GREEN/RED (NC)
- GRAY/RED (NC)
- GRAY/YELLOW (NC)
- BLACK (NC)

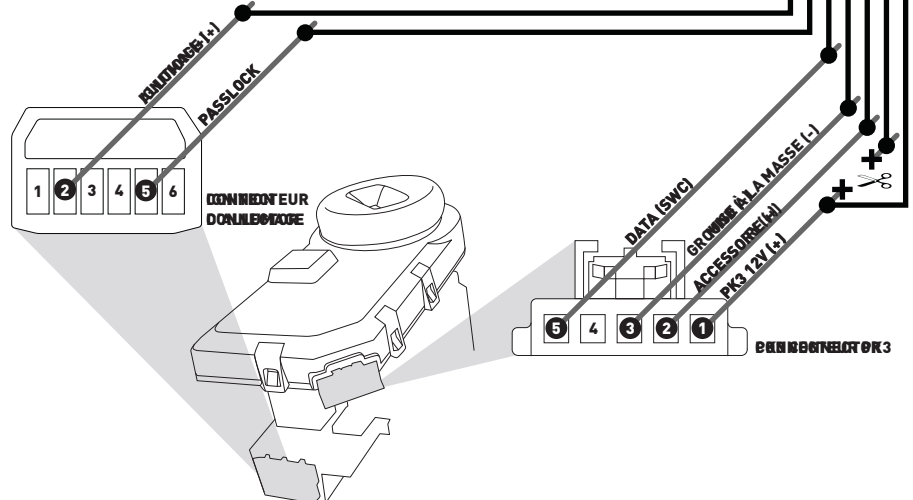

CARTRIDGE INSTALLATION

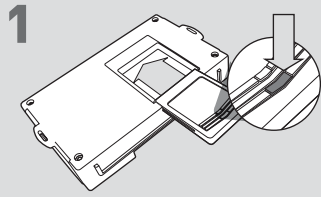

1 Slide cartridge into unit. Notice button under LED.

2

Ready for Module Programming Procedure.

MODULE PROGRAMMING PROCEDURE - WITH KLON

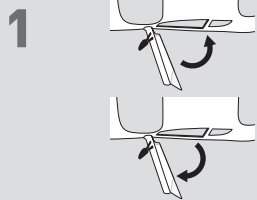

1 Close driver door.

Re-open driver door to wake up data bus.

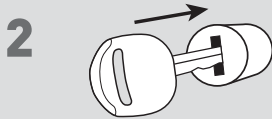

2 Insert key into ignition.



3 Turn key to ON position.

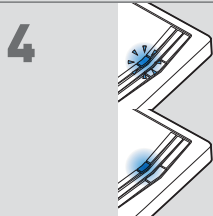

4 Wait, this may take up to 1 minute.

If LED flashes BLUE, proceed with step 5.
If LED turns solid BLUE, proceed with step 11.

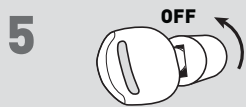

5 Turn key to OFF position.

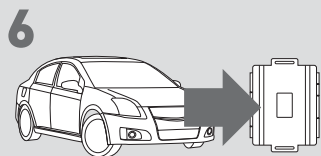

6 **WARNING:**
Disconnect power last.
Disconnect RS from vehicle.

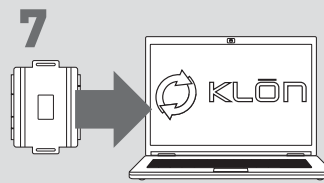

7 Connect RS to computer and proceed with extended programming.

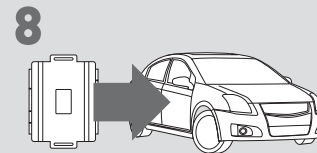

8 **WARNING:** Do not press RS programming button.
Connect power first.
Connect RS to vehicle.



9 Repeat steps 1 to 3.



10 Wait, LED will turn solid BLUE for **2 seconds**.



11 Turn key to OFF position.

12

Module Programming Procedure completed.

IDENTIFY VEHICLE YEAR

1

Locate the Vehicle Identification Number (VIN) and identify the 10th character.



2

Match the VIN's 10th character to its corresponding year.

L → 1990	S → 1995	Y → 2000	5 → 2005	A → 2010
M → 1991	T → 1996	1 → 2001	6 → 2006	B → 2011
N → 1992	V → 1997	2 → 2002	7 → 2007	C → 2012
P → 1993	W → 1998	3 → 2003	8 → 2008	D → 2013
R → 1994	X → 1999	4 → 2004	9 → 2009	E → 2014

MODULE DIAGNOSTICS

LED STATUS	DIAGNOSTICS		
	DURING PROGRAMMING	DURING REMOTE START	WITH IGNITION OFF
Flashing RED	Missing/wrong information from firmware or vehicle	Incorrectly programmed	Incorrectly programmed or connected
Solid RED	Waiting for more vehicle information	Incorrectly programmed	Not programmed waiting for more vehicle information
Flashing BLUE	Additional steps required to complete programming	Correctly programmed and operational	False ground when running status from remote starter
Solid BLUE then OFF	Correctly programmed	Reset in progress	Reset in progress
OFF	No activity or already programmed	Invalid ground when running status from remote starter	At rest and ready for a remote start sequence

FACTORY RESET PROCEDURE

1

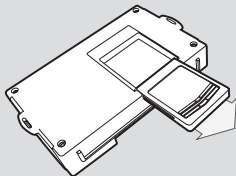

DISCONNECT cartridge from remote starter.

2

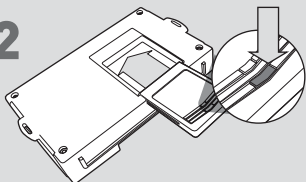

PRESS AND HOLD programming button while re-connecting cartridge to remote starter.

3

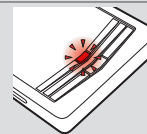

LED will flash red. Immediately **RELEASE** programming button.

4

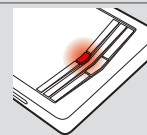

LED will turn solid red for 2 seconds.

RESET COMPLETED.

5

RECONNECT all connectors. Repeat programming procedure.



Failure to follow procedure may result with a DTC or a CHECK ENGINE error message.