

# BLADE

SERIES

Automotive Data Solutions Inc.

## INSTALL GUIDE BLADE-AL(DL)-CH6

# CH6

**AVAILABLE FOR: ADS-BLADE AL**

*Rev. Date: September 02, 2010*

*Doc. No.: ##3848##*

*20100901*

VERSION FRANÇAISE DISPONIBLE EN LIGNE AU [WWW.BLADEUPDATE.COM](http://WWW.BLADEUPDATE.COM)

PLEASE VISIT [WWW.BLADEUPDATE.COM](http://WWW.BLADEUPDATE.COM) FOR COMPLETE PRODUCT DETAILS

The brand names and logos found in this guide are property of their respective owners. Automotive Data Solutions Inc. © 2010

CHRYSLER

Jeep



DODGE

**NOTICE:** The manufacturer will accept no responsibility for any electrical damage resulting from improper installation of this product, be that either damage to the vehicle itself or to the installed device. This device must be installed by a certified technician. This guide has been written for properly trained technicians; a certain level of skill & knowledge is therefore assumed. Please review the Installation Guide carefully before beginning any work.

## INSTALL TYPE SELECTION

MAKE	MODEL	YEAR	INSTALL TYPE	FEATURES																
				DATA IMMOBILIZER BYPASS	DOWNLOADABLE SOFTWARE	RS232 COMMUNICATION	2-WAY COMPATIBILITY	PRIORITY UNLOCK	DOOR LOCK	DOOR UNLOCK	ARM OEM ALARM	DISARM OEM ALARM	POWER LIFTGATE	TRUNK/HATCH RELEASE	POWER SLIDING DOOR (L)	POWER SLIDING DOOR (R)	DOOR STAT OUTPUT	TRUNK STAT OUTPUT	TACHOMETER OUTPUT	DATA/MUX STARTER CTRL
CHRYSLER	300M	99-04	1	•	•	•	•	•	•	•	•	•	•	•	•	•	•	•	•	•
	300M w/Alarm	99-04	3	•	•	•	•	•	•	•	•	•	•	•	•	•	•	•	•	•
	Concorde	99-04	1	•	•	•	•	•	•	•	•	•	•	•	•	•	•	•	•	•
	Concorde w/Alarm	99-04	3	•	•	•	•	•	•	•	•	•	•	•	•	•	•	•	•	•
	LHS	99-01	1	•	•	•	•	•	•	•	•	•	•	•	•	•	•	•	•	•
	LHS w/Alarm	99-01	3	•	•	•	•	•	•	•	•	•	•	•	•	•	•	•	•	•
	Neon	00-05	3	•	•	•	•	•	•	•	•	•	•	•	•	•	•	•	•	•
	Pacifica	04-08	2	•	•	•	•	•	•	•	•	•	•	•	•	•	•	•	•	•
	PT Cruiser	01-05	3	•	•	•	•	•	•	•	•	•	•	•	•	•	•	•	•	•
	Sebring Sedan/Convertible	01-06	1	•	•	•	•	•	•	•	•	•	•	•	•	•	•	•	•	•
	Sebring Sedan/Convertible w/Alarm	01-06	3	•	•	•	•	•	•	•	•	•	•	•	•	•	•	•	•	•
	Town & Country	01-03	4	•	•	•	•	•	•	•	•	•	•	•	•	•	•	•	•	•
	Town & Country w/Alarm	01-03	5	•	•	•	•	•	•	•	•	•	•	•	•	•	•	•	•	•
	Town & Country	04-07	2	•	•	•	•	•	•	•	•	•	•	•	•	•	•	•	•	•
	Voyager	01-03	4	•	•	•	•	•	•	•	•	•	•	•	•	•	•	•	•	•
Voyager w/Alarm	01-03	5	•	•	•	•	•	•	•	•	•	•	•	•	•	•	•	•	•	
DODGE	Caravan/Grand Caravan	01-03	4	•	•	•	•	•	•	•	•	•	•	•	•	•	•	•	•	
	Caravan/Grand Caravan w/Alarm	01-03	5	•	•	•	•	•	•	•	•	•	•	•	•	•	•	•	•	
	Caravan/Grand Caravan	04-07	2	•	•	•	•	•	•	•	•	•	•	•	•	•	•	•	•	
	Dakota	01-04	6	•	•	•	•	•	•	•	•	•	•	•	•	•	•	•	•	
	Dakota w/Alarm	01-04	3	•	•	•	•	•	•	•	•	•	•	•	•	•	•	•	•	
	Durango	01-03	6	•	•	•	•	•	•	•	•	•	•	•	•	•	•	•	•	
	Durango w/Alarm	01-03	3	•	•	•	•	•	•	•	•	•	•	•	•	•	•	•	•	
	Intrepid	99-04	1	•	•	•	•	•	•	•	•	•	•	•	•	•	•	•	•	
	Intrepid w/Alarm	99-04	3	•	•	•	•	•	•	•	•	•	•	•	•	•	•	•	•	
	Ram Pickup	02-05	3	•	•	•	•	•	•	•	•	•	•	•	•	•	•	•	•	
	SRT 4	03-05	3	•	•	•	•	•	•	•	•	•	•	•	•	•	•	•	•	
	Stratus Sedan	01-06	1	•	•	•	•	•	•	•	•	•	•	•	•	•	•	•	•	
	Stratus Sedan w/Alarm	01-06	3	•	•	•	•	•	•	•	•	•	•	•	•	•	•	•	•	
SX 2.0	03-05	3	•	•	•	•	•	•	•	•	•	•	•	•	•	•	•	•		
JEEP	Grand Cherokee	99-04	1	•	•	•	•	•	•	•	•	•	•	•	•	•	•	•	•	
	Liberty	02-04	3	•	•	•	•	•	•	•	•	•	•	•	•	•	•	•	•	
	Liberty	05-07	2	•	•	•	•	•	•	•	•	•	•	•	•	•	•	•	•	
	TJ	01-06	1	•	•	•	•	•	•	•	•	•	•	•	•	•	•	•	•	
	Wrangler	01-06	1	•	•	•	•	•	•	•	•	•	•	•	•	•	•	•	•	
PLYMOUTH	Neon	00-01	3	•	•	•	•	•	•	•	•	•	•	•	•	•	•	•	•	

Visit our website for advanced features.

† Extra resistor and relay required.

\* Brake output available ONLY with ignition ON.

## DETECT OEM ALARM EQUIPPED VEHICLES

### WITH OEM KEYFOB

### WITHOUT OEM KEYFOB

**1** Close hood and trunk/hatch.  
Enter vehicle.  
Close all doors.

**1** Open driver's door window.  
Close hood and trunk/hatch.  
Close all doors.

**2** Press LOCK twice on OEM fob.



Wait 60 seconds.

**2** LOCK driver's door twice using OEM key.

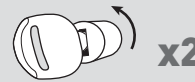

Wait 60 seconds.

**3** Open driver's door.

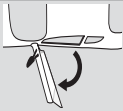

Alarm goes on,  
OEM alarm equipped vehicle.

**3** Open driver's door using handle located inside vehicle.

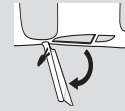

Alarm goes on,  
OEM alarm equipped vehicle.

## TYPE 1 - WIRE CROSS REFERENCE CHART

MAKE	MODEL	YEAR	IGNITION		J1850	
			WIRE COLOR	POSITION	WIRE COLOR	POSITION
CHRYSLER	300M <sup>2</sup>	99-04	Blue/White	4	Violet/Yellow	2
	Concorde <sup>2</sup>	99-04	Blue/White	4	Violet/Yellow	2
	LHS <sup>2</sup>	99-01	Blue/White	4	Violet/Yellow	2
	Sebring Sedan/Convertible <sup>2</sup>	01-06	Blue/White	4	Violet/Pink	2
DODGE	Intrepid <sup>2</sup>	99-04	Blue/White	4	Violet/Yellow	2
	Stratus Sedan <sup>2</sup>	01-06	Blue/White	4	Violet/Pink	2
JEEP	Grand Cherokee <sup>1&amp;2</sup>	99-04	Blue/White	3	Yellow/Violet or Yellow/Black	5
	TJ <sup>1&amp;2</sup>	01-04	Blue	4	Violet/Yellow	2
	TJ <sup>1&amp;2</sup>	05-06	Pink/White	4	White/Violet	2
	Wrangler <sup>1&amp;2</sup>	01-04	Blue	4	Violet/Yellow	2
	Wrangler <sup>1&amp;2</sup>	05-06	Pink/White	4	White/Violet	2

<sup>1</sup> With OEM Alarm

<sup>2</sup> Without OEM Alarm

## TYPE 1 - WIRING DIAGRAM

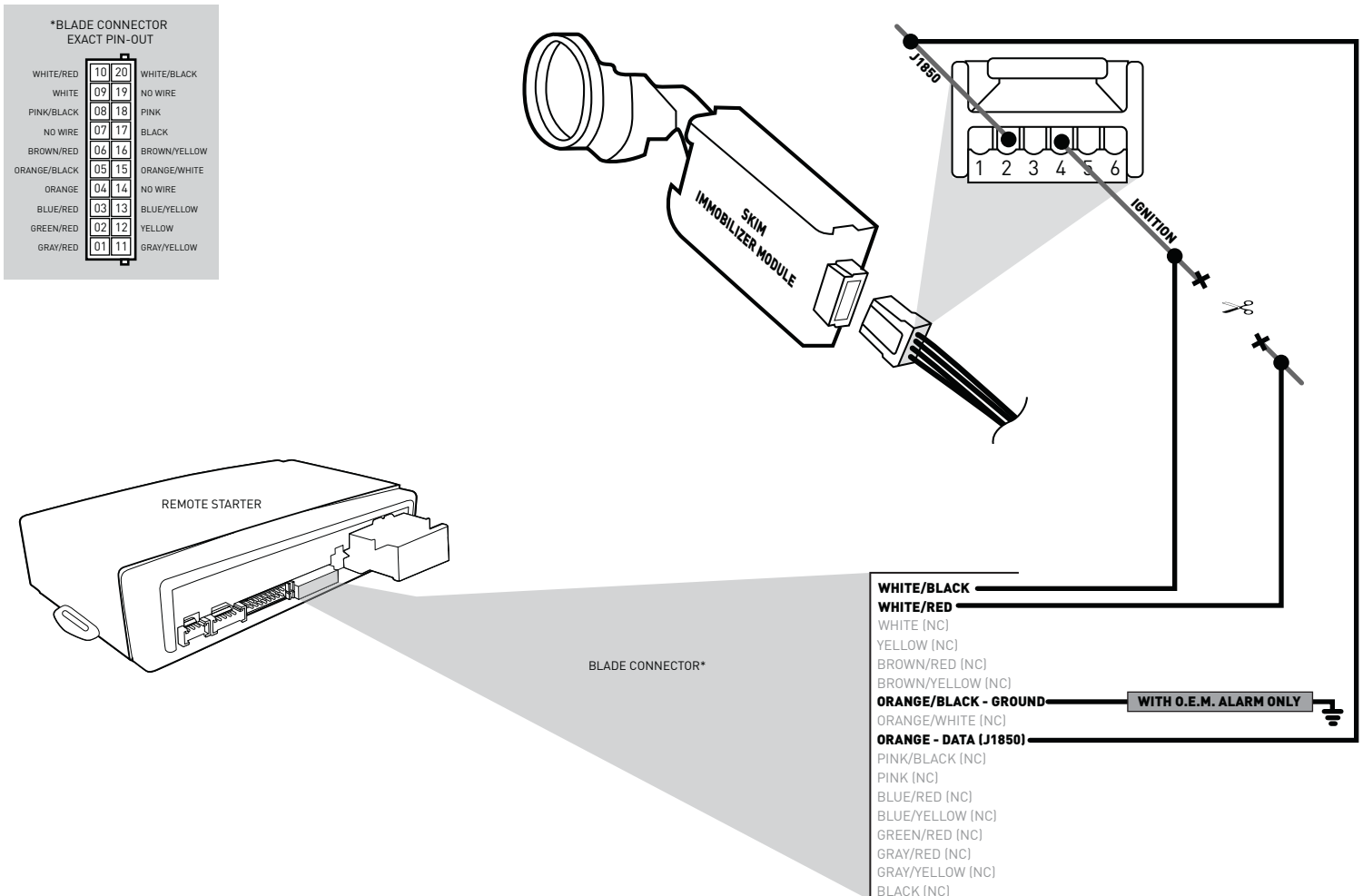

## TYPE 2 - WIRE CROSS REFERENCE CHART

MAKE	MODEL	YEAR	IGNITION	J1850
			WIRE COLOR	WIRE COLOR
CHRYSLER	Pacifica	04-08	Pink/Gray	White/Violet
	Town & Country	04-07	Pink/White	White/Violet
DODGE	Caravan/Grand Caravan	04-07	Pink/White	White/Violet
JEEP	Liberty	05-07	Pink/LtGreen	White/Violet

## TYPE 2 - WIRING DIAGRAM

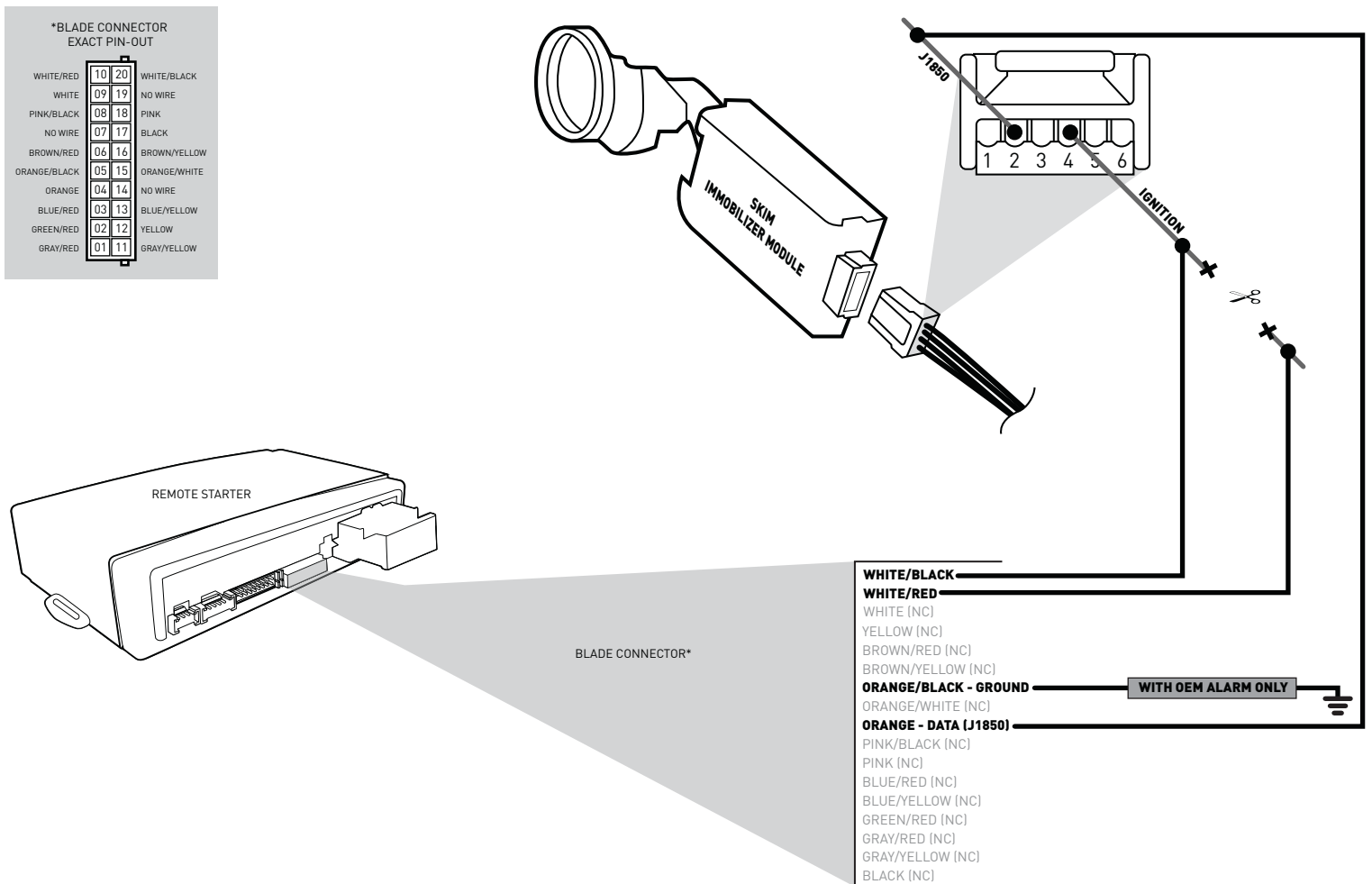

## TYPE 3 - COMPONENT LOCATOR

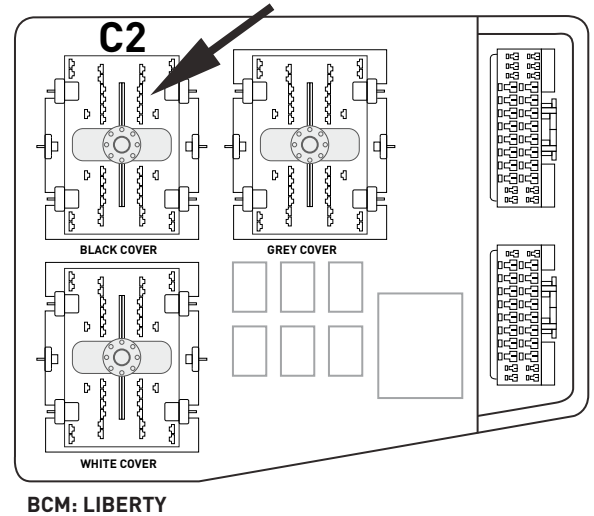
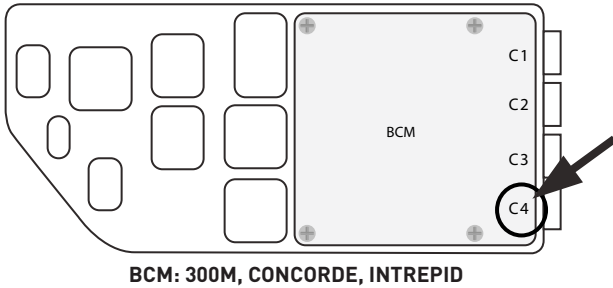

## TYPE 3 - WIRE CROSS REFERENCE CHART

MAKE	MODEL	YEAR	ANALOG DOORLOCK		IGNITION	J1850
			WIRE COLOR	LOCATION		
CHRYSLER	300M <sup>1</sup>	99-04	LtGreen/Orange	At BCM, C4 Connector, Pin #13 (See BCM image)	Blue/White	Violet/Yellow
	Concorde <sup>1</sup>	99-04	LtGreen/Orange	At BCM, C4 Connector, Pin #13 (See BCM image)	Blue/White	Violet/Yellow
	LHS <sup>1</sup>	99-01	LtGreen/Orange	At BCM, C4 Connector, Pin #13 (See BCM image)	Blue/White	Violet/Yellow
	Neon <sup>1&amp;2</sup>	00-05	LtGreen	Harness coming from driver door	Blue/White	Violet/Yellow
	PT Cruiser <sup>1</sup>	01-05	White/DkGreen	Harness coming from driver door	Blue/Black	Violet/Yellow
	Sebring Convertible <sup>1</sup>	01-06	LtGreen/Orange	At BCM, C4 Connector, Pin #4 or Harness from driver door	Blue/White	Violet/Pink
	Sebring Sedan <sup>1</sup>	01-06	LtGreen/Orange	At BCM, C4 Connector, Pin #4 or Harness from driver door	Blue/White	Violet/Pink
DODGE	Dakota <sup>1</sup>	01-04	LtGreen/Orange	Driver Kick Panel	LtGreen/Black	Violet/Yellow
	Durango <sup>1</sup>	01-03	LtGreen/Orange	Driver Kick Panel	LtGreen/Black	Violet/Yellow
	Intrepid <sup>1</sup>	99-04	LtGreen/Orange	At BCM, C4 Connector, Pin #13 (See BCM image)	Blue/White	Violet/Yellow
	Ram Pickup <sup>2</sup>	02-03	White/LtGreen	Driver Kick Panel	LtGreen/Black	Violet/White
	Ram Pickup <sup>1</sup>	02-03	LtGreen/Orange	Driver Kick Panel	LtGreen/Black	Violet/White
	Ram Pickup <sup>2</sup>	04-05	Purple/DkGreen	Driver Kick Panel	Pink/Gray	White/Violet
	Ram Pickup <sup>1</sup>	04-05	Purple/LtBlue	Driver Kick Panel	Pink/Gray	White/Violet
	SRT 4 <sup>1&amp;2</sup>	03-05	LtGreen	Harness coming from driver door	Blue/White	Violet/Yellow
	Stratus Sedan <sup>1</sup>	01-06	LtGreen/Orange	At BCM, C4 Connector, Pin #4 or Harness from driver door	Blue/White	Violet/Pink
SX 2.0 <sup>1&amp;2</sup>	03-05	LtGreen	Harness coming from driver door	Blue/White	Violet/Yellow	
JEEP	Liberty <sup>1&amp;2</sup>	02-04	Pink/Violet	At BCM, C2 Connector, Pin #20 (See BCM image)	Blue	Yellow/Violet or Violet/Black
PLYMOUTH	Neon <sup>1&amp;2</sup>	00-01	LtGreen	Harness coming from driver door	Blue/White	Violet/Yellow

<sup>1</sup> With OEM Alarm

<sup>2</sup> Without OEM Alarm

## TYPE 3 - WIRING DIAGRAM

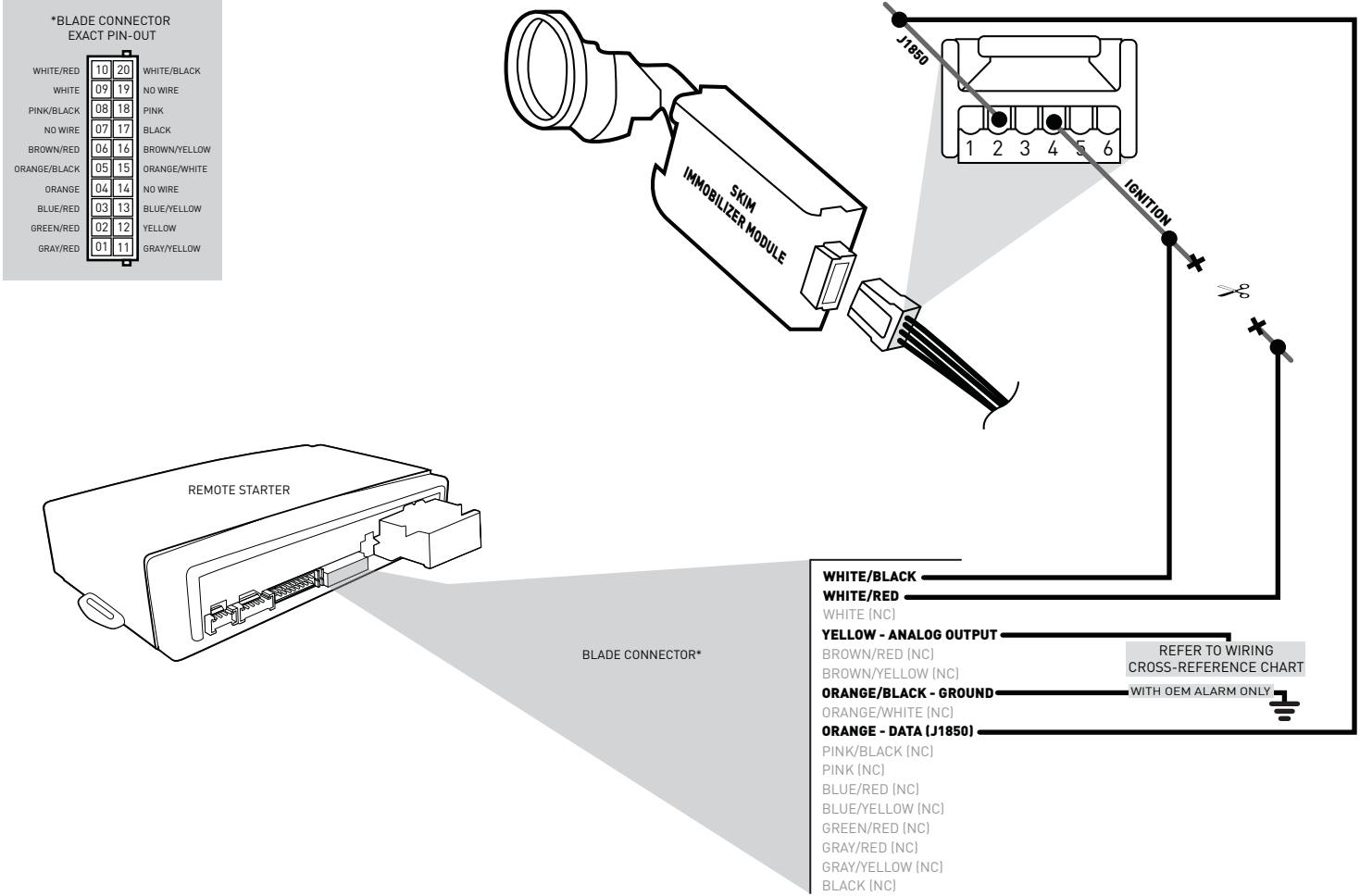

## TYPE 4 - WIRING DIAGRAM

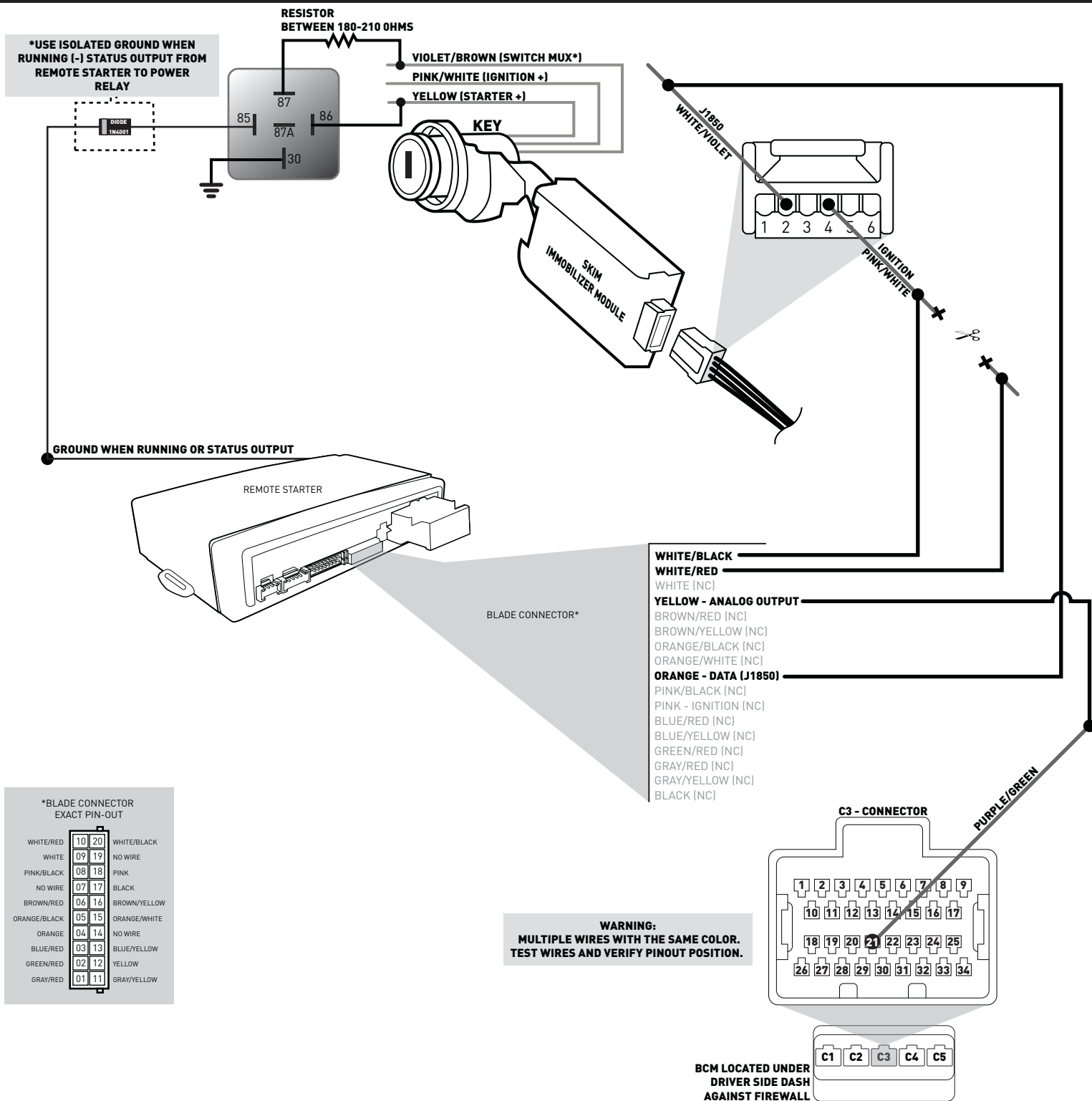

**\*BLADE CONNECTOR EXACT PIN-OUT**

WHITE/RED	10	20	WHITE/BLACK
WHITE	09	19	NO WIRE
PINK/BLACK	08	18	PINK
NO WIRE	07	17	BLACK
BROWN/RED	06	16	BROWN/YELLOW
ORANGE/BLACK	05	15	ORANGE/WHITE
ORANGE	04	14	NO WIRE
BLUE/RED	03	13	BLUE/YELLOW
GREEN/RED	02	12	YELLOW
GRAY/RED	01	11	GRAY/YELLOW



## TYPE 5 - WIRING DIAGRAM

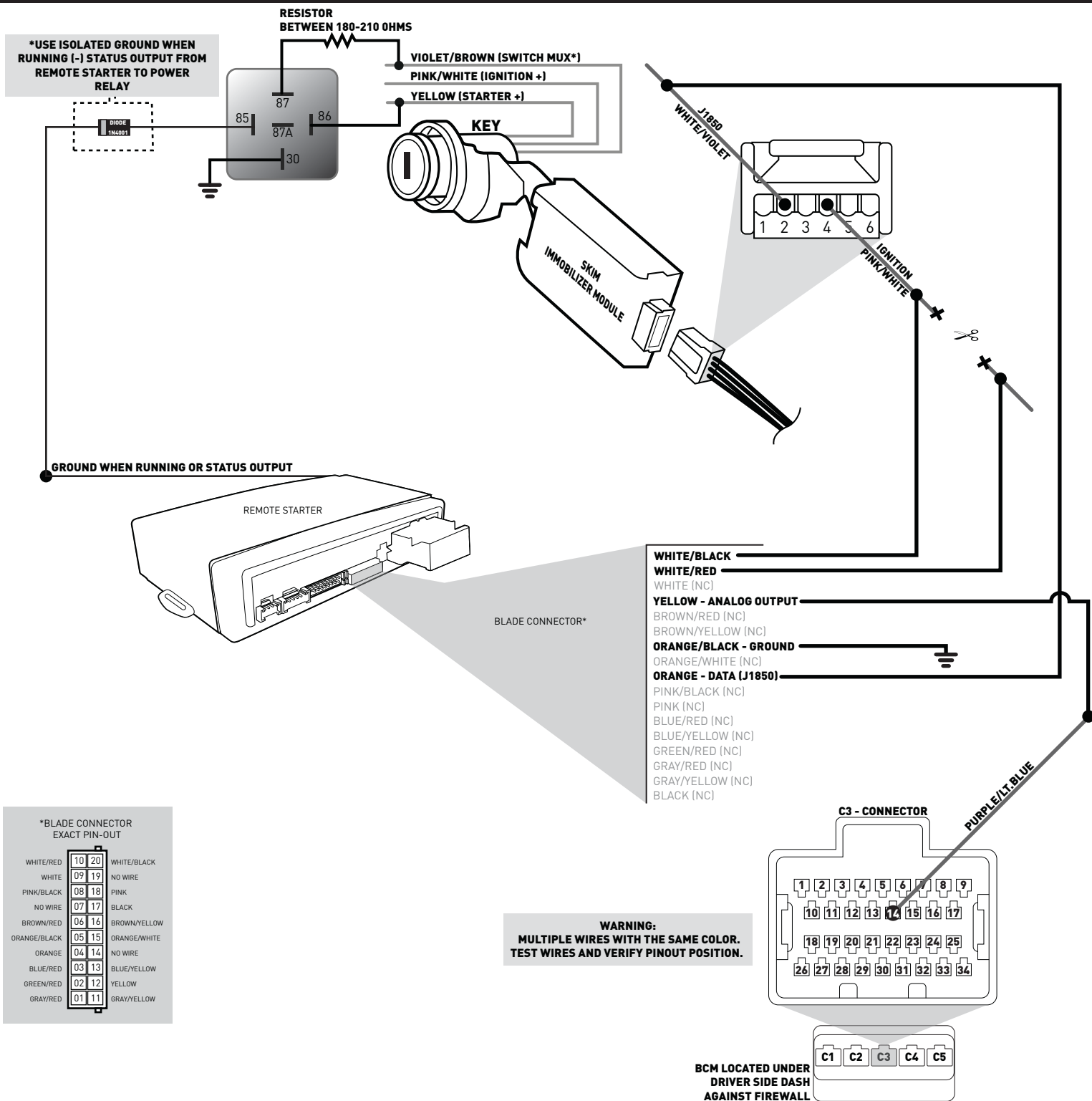

**\*BLADE CONNECTOR EXACT PIN-OUT**

WHITE/RED	10	20	WHITE/BLACK
WHITE	09	19	NO WIRE
PINK/BLACK	08	18	PINK
NO WIRE	07	17	BLACK
BROWN/RED	06	16	BROWN/YELLOW
ORANGE/BLACK	05	15	ORANGE/WHITE
ORANGE	04	14	NO WIRE
BLUE/RED	03	13	BLUE/YELLOW
GREEN/RED	02	12	YELLOW
GRAY/RED	01	11	GRAY/YELLOW

## TYPE 6 - WIRING DIAGRAM

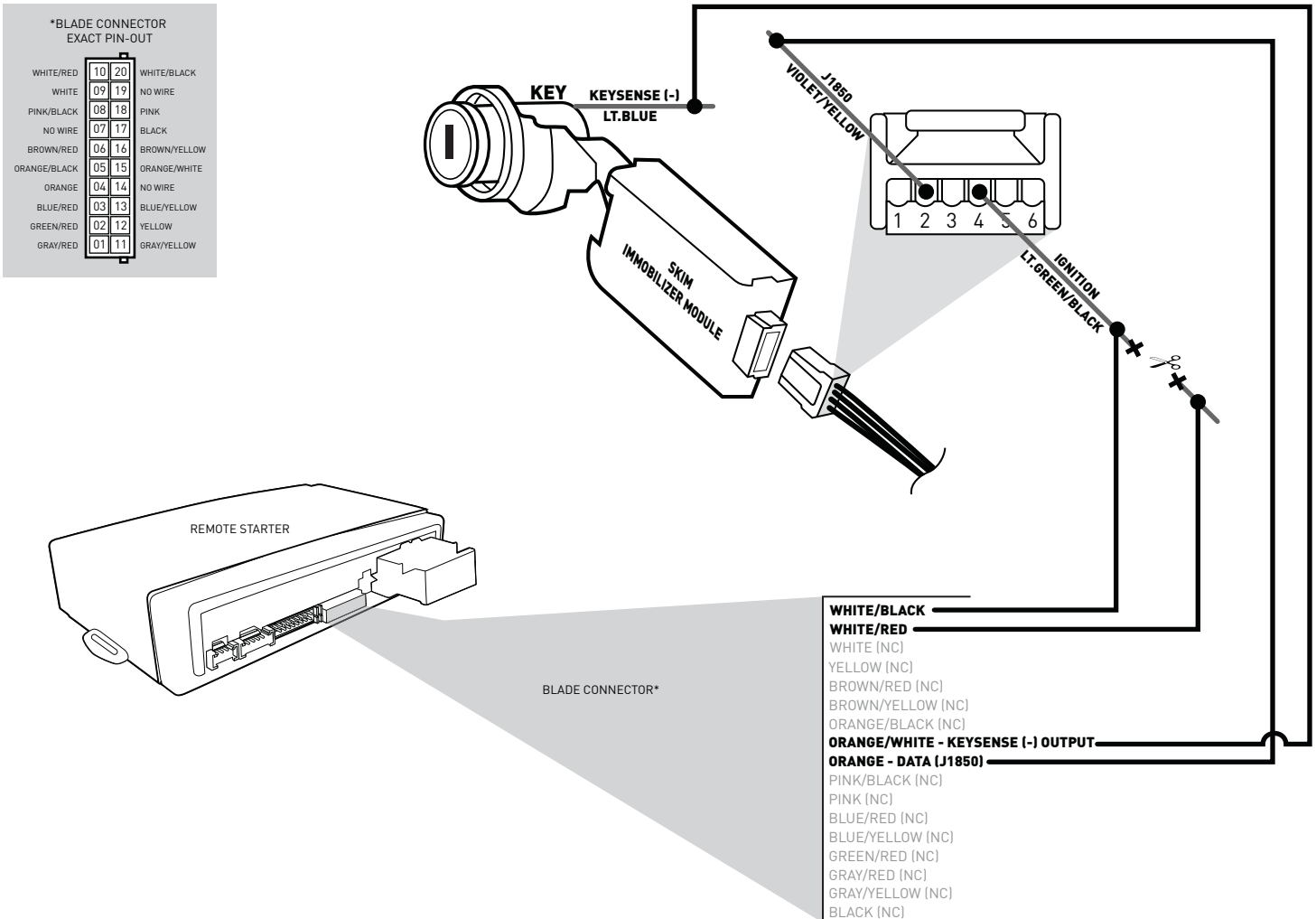

## CARTRIDGE INSTALLATION

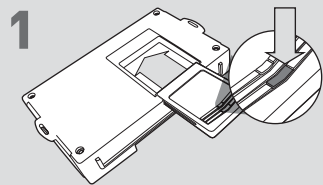

**1** Slide cartridge into unit. Notice button under LED.

**2**

Ready for Module Programming Procedure.

## MODULE PROGRAMMING PROCEDURE

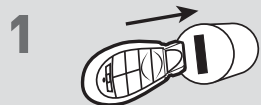

**1** Insert key into ignition.



**2** Turn key to ON position.

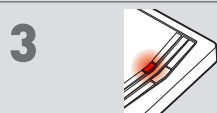

**3** LED will turn solid RED.

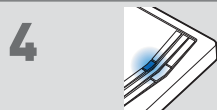

**4** Wait, it may take up to **20 seconds**. LED will turn solid BLUE then will turn OFF.



**5** Turn key to OFF position.

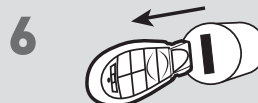

**6** Remove key.

**7**

Module Programming Procedure completed.

## MODULE DIAGNOSTICS

### DURING PROGRAMMING

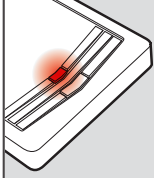

**SOLID RED**  
waiting  
for more vehicle  
information

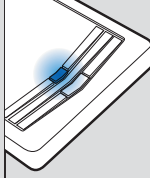

**SOLID BLUE  
THEN OFF**  
correctly  
programmed

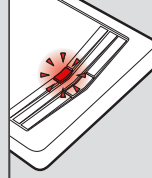

**FLASHING RED**  
missing/wrong  
connection or  
firmware

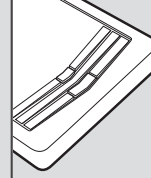

**LED OFF**  
no activity  
or already  
programmed

### DURING REMOTE START (R.S.)

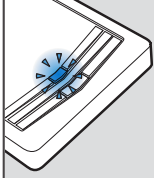

**FLASHING BLUE**  
correctly  
programmed  
and operational

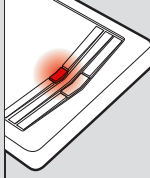

**SOLID RED**  
incorrectly  
programmed

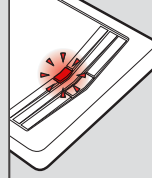

**FLASHING RED**  
incorrectly  
programmed

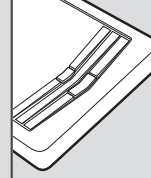

**LED OFF**  
invalid ground  
when running  
status from r.s.

### WITH IGNITION OFF

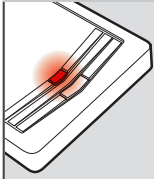

**SOLID RED**  
waiting  
for more vehicle  
information

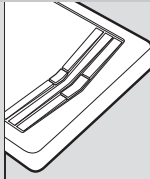

**LED OFF**  
at rest and  
ready for a  
r.s. sequence

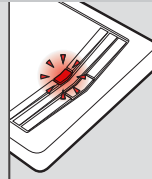

**FLASHING RED**  
incorrectly  
programmed  
or connected

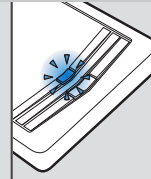

**FLASHING BLUE**  
false ground  
when running  
status from r.s.

## FACTORY RESET PROCEDURE

**1 DISCONNECT** BLADE from remote starter.

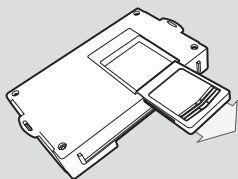

**2 PRESS AND HOLD** programming button while re-connecting BLADE to remote starter.

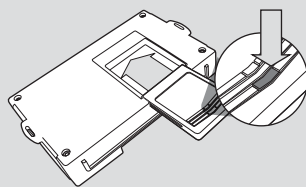

**3** LED will flash red. Immediately **RELEASE** programming button.

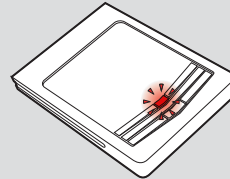

**4** LED will turn solid red for 2 seconds, **RESET COMPLETED**. Reconnect all connectors and repeat programming procedure.

